



CSW | ST 2

CSW/Stuber-Stroeh Engineering Group, Inc.

504 Redwood Blvd. Novato, CA 94947
tel: 415.883.9850 fax: 415.883.9835

Civil Engineers
Surveying & Mapping
Land Planning
Construction Management

CITY OF SAUSALITO DEPARTMENT OF PUBLIC WORKS

PLANS FOR CONSTRUCTION OF 2023 PAVEMENT IMPROVEMENT PLANS

CITY PROJECT NO: 07.01.008

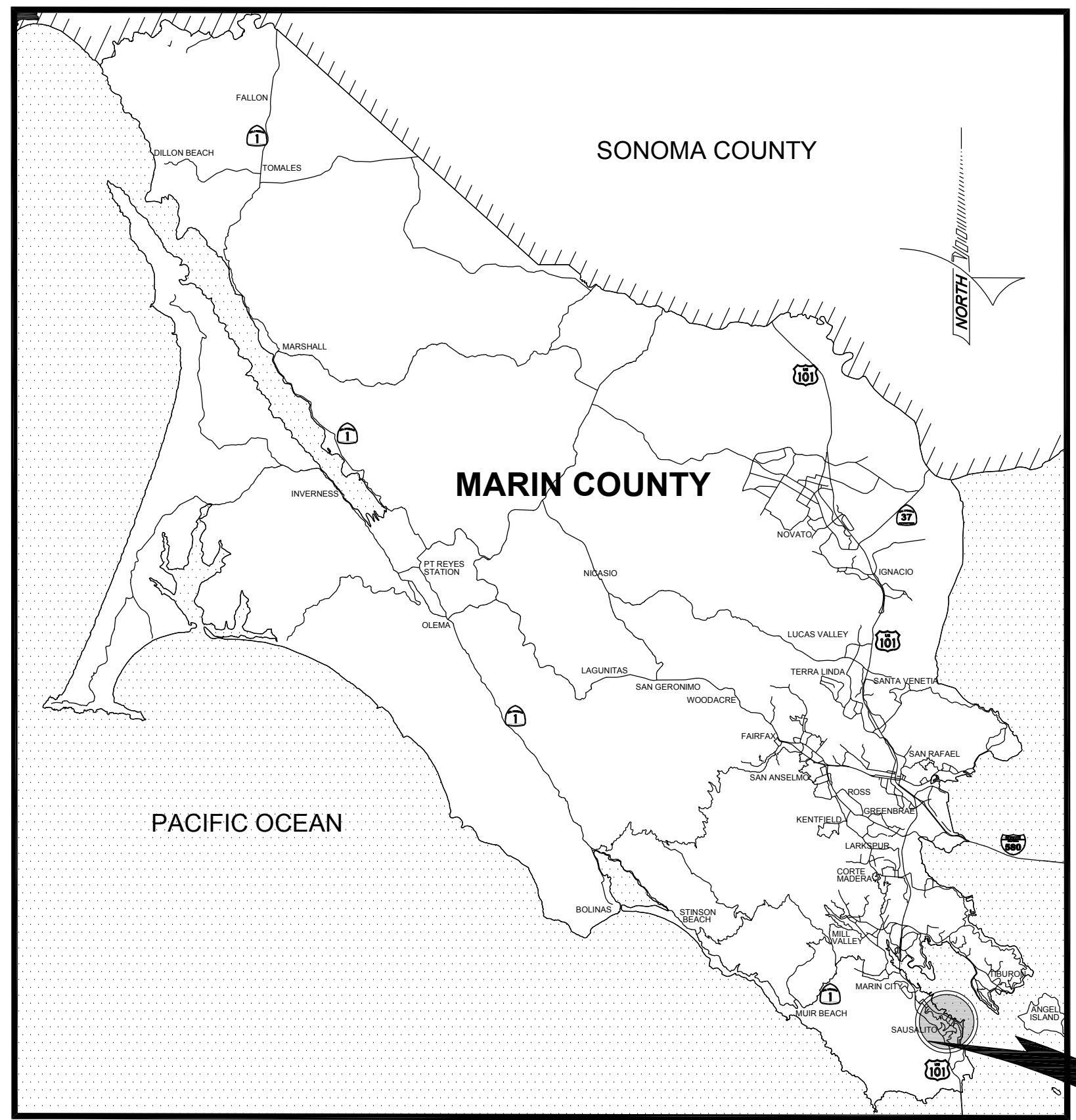

LOCATION MAP
NOT TO SCALE

| SHEET INDEX | | |
|-------------|-----|--|
| SHEET NO. | NO. | SHEET TITLE |
| C1.00 | 1 | COVER SHEET |
| C1.01 | 2 | GENERAL NOTES, ABBREVIATIONS, & SYMBOLS |
| C2.00 | 3 | PAVEMENT PLAN - PLAN & PROFILE (STA 1+15 to 4+20) |
| C2.01 | 4 | PAVEMENT PLAN - PLAN & PROFILE (STA 4+20 to 7+30) |
| C2.02 | 5 | PAVEMENT PLAN - PLAN & PROFILE (STA 7+30 to 10+35) |
| C3.00 | 6 | SEWER PLAN - PLAN & PROFILE (STA 1+00 to 3+50) |
| C3.01 | 7 | SEWER PLAN - PLAN & PROFILE (STA 3+50 to 6+50) |
| C3.02 | 8 | SEWER PLAN - PLAN & PROFILE (STA 6+50 to 9+50) |
| C3.03 | 9 | SEWER PLAN - PLAN & PROFILE (STA 9+50 to 12+55) |
| C4.00 | 10 | DETAIL SHEET - ROADWAY IMPROVEMENTS |
| C4.01 | 11 | DETAIL SHEET - SANITARY SEWER SYSTEM |



PROJECT LOCATION
1-INCH - 200 FT

| Rev | Date | Description | Designed | Drawn | Checked |
|-----|----------|-------------|----------|-------|---------|
| A | 09/20/23 | BID SET | RJS | JP | RJS |

**STREET REHABILITATION
COVER SHEET
SAUSALITO, CALIFORNIA**

City Of
Sausalito
County Of
Marin
State Of
California

Prepared Under the Direction of:

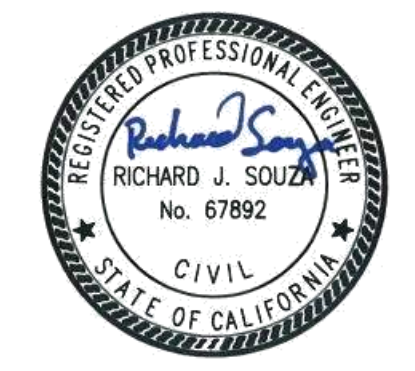

Sheet
C1.00
Scale: AS SHOWN
Date: September 20, 2023
Sheet Number: 1 OF 11

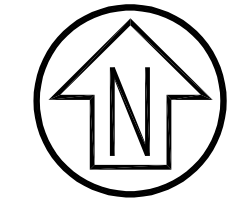

W:\proj\Drawings\Sheet\Project\07.01.008\07.01.008_10_Sausalito_Street_Rehabilitation_Edwards\DWG\Sheet\C1.00 - COVER.dwg 09/20/2023 - 10:49 AM DWG 1:1 5/02

ABBREVIATIONS

| | | | |
|------|--------------------------------|--------|---|
| AB | AGGREGATE BASE | MMWD | MARIN MUNICIPAL WATER DISTRICT |
| AC | ASPHALT CONCRETE | NTS | NOT TO SCALE |
| ACP | ASBESTOS CEMENT PIPE | POC | POINT ON CURVE |
| AD | AREA DRAIN | PCC | PORTLAND CEMENT CONCRETE |
| C&G | CURB & GUTTER | PRC | POINT OF REVERSE CURVE |
| CB | CATCH BASIN | PVC | POLYVINYL CHLORIDE PIPE |
| CIP | CAST IRON PIPE | R.C. | RELATIVE COMPACTION |
| CL | CENTERLINE / CONTROL LINE | RCP | REINFORCED CONCRETE PIPE |
| CONC | CONCRETE | ROW | RIGHT OF WAY |
| CP | CONTROL POINT | SD | STORM DRAIN |
| DI | DROP INLET | SDCO | STORM DRAIN CLEANOUT |
| EG | EXISTING GRADE | SDMH | STORM DRAIN MAINTENANCE HOLE |
| EL | ELEVATION | SF | SQUARE FEET |
| EX | EXISTING | SL | STREET LIGHT |
| FG | FINISH GRADE | SS | SANITARY SEWER |
| FH | FIRE HYDRANT | SSMH | SANITARY SEWER MAINTENANCE HOLE |
| FL | FLOWLINE | TC | TOP OF CURB |
| FS | FINISH SURFACE | TC DEP | TOP OF CURB DEPRESSION |
| GB | GRADE BREAK | TW | TOP OF WALL |
| HDPE | HIGH DENSITY POLYETHYLENE PIPE | tw | TOE OF WALL |
| HP | HIGH POINT | TYP | TYPICAL |
| INV | INVERT | UCS | MARIN COUNTY UNIFORM CONSTRUCTION STANDARDS |
| JT | JOINT TRENCH | UNO | UNLESS NOTED OTHERWISE |
| LF | LINEAR FEET | VIF | VERIFY IN FIELD |
| LOS | LINE OF SIGHT | WSP | WELDED STEEL PIPE |
| LP | LOW POINT | | |
| MH | MAINTENANCE HOLE | | |

LINETYPES

| EXISTING | | PROPOSED |
|----------|---------------------|----------|
| | ELECTRICAL LINE | N/A |
| | GAS LINE | N/A |
| | WATER LINE | N/A |
| | OVERHEAD UTILITY | N/A |
| | SANITARY SEWER LINE | SS |
| | STORM DRAIN | N/A |
| | CENTERLINE | N/A |
| | CONTOUR - MAJOR | |
| | CONTOUR - MINOR | |
| | SAWCUT | |
| | RIGHT OF WAY | |

SYMBOLS

| EXISTING | | PROPOSED |
|----------|--------------------------------------|----------|
| | SIGN | N/A |
| | FOUND / SET - CONTROL POINT | N/A |
| | FOUND / SET - SURVEY STREET MONUMENT | N/A |
| | STORM DRAINAGE - DROP INLET | N/A |
| | GAS VALVE | N/A |
| | FIRE HYDRANT | N/A |
| | GRADE | 1.0% |
| | SANITARY SEWER MAINTENANCE HOLE | |

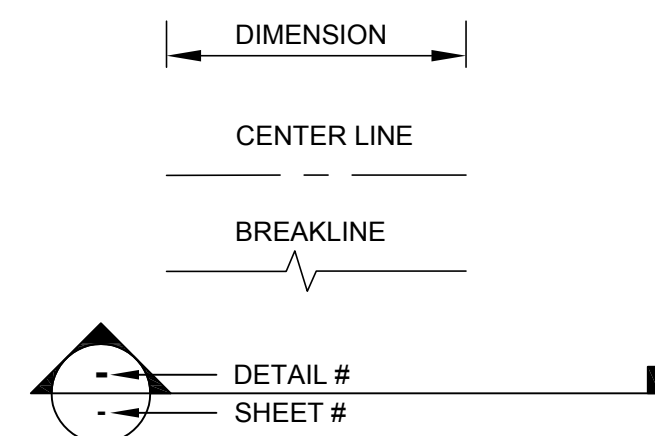

CONSTRUCTION NOTES:

- SAWCUT EXISTING PAVEMENT AT LIMIT OF WORK, TYPICAL.
- PROTECT ALL DRAINAGE AND SEWAGE STRUCTURES AND PIPES FROM INFILTRATION OF ALL CONSTRUCTION DEBRIS FOR THE DURATION OF THE WORK, PER STORMWATER POLLUTION PREVENTION PLAN (SWPPP).

GENERAL NOTES:

- ALL WORK SHOWN ON THESE PLANS SHALL BE ACCOMPLISHED IN ACCORDANCE WITH THE SPECIAL PROVISIONS, THE UNIFORM CONSTRUCTION STANDARDS OF THE CITIES OF MARIN AND THE COUNTY OF MARIN DATED JULY, 2018, THE STATE STANDARD PLANS DATED 2018, AND THE STATE STANDARD SPECIFICATION DATED 2018, (INSOFAF AS THE SAME MAY APPLY) AS MODIFIED BY THE REVISED STANDARD PLANS AND SPECIFICATIONS IN EFFECT ON THE DATE OF THESE PLANS, AND THE SPECIAL PROVISIONS FOR THIS PROJECT.
- UTILITY LOCATIONS SHOWN ON THESE PLANS ARE APPROXIMATE ONLY AND MAY NOT BE COMPLETE. THERE MAY BE ADDITIONAL UTILITIES NOT SHOWN. IT SHALL BE THE SOLE RESPONSIBILITY OF THE CONTRACTOR TO VERIFY THE PRESENCE OF UTILITIES WITHIN THE WORK LIMITS, THEIR LOCATION AND THEIR DEPTH. VERIFICATION SHALL BE COORDINATED BY THE CONTRACTOR WITH USA NORTH, THE APPROPRIATE UTILITY OWNERS, AND BY PRUDENT EXAMINATION OF THE SITE FOR INDICATIONS THAT OVERHEAD OR SUBSURFACE INSTALLATIONS EXIST SUCH AS: MAINTENANCE HOLES, VALVE COVERS, WATER METERS SEWER CLEANOUTS, GAS METERS, POLE RISERS, CABINETS, TRAFFIC LIGHTS, STREET LIGHTS, DRAINAGE INLETS AND ETC. CALL U.S.A. NORTH (UNDERGROUND SERVICE ALERT) 811, AND FOLLOW THE PROCEDURES SPECIFIED IN THE USA NORTH 811 EXCAVATION HANDBOOK.
- PRIOR TO STARTING AN EXCAVATION, EXAMINE THE SITE FOR INDICATIONS THAT UNMARKED SUBSURFACE INSTALLATIONS EXIST. SEWER LATERALS AND PRIVATE STORM DRAINS ARE EXAMPLES OF UTILITIES NOT MARKED BY UNDERGROUND SERVICE ALERT. CONTRACTOR IS RESPONSIBLE FOR LOCATING, POTHOLING, AND PROTECTING ALL UTILITIES IN PLACE, UNLESS OTHERWISE NOTED.
- THE CONTRACTOR IS RESPONSIBLE FOR MAINTAINING ADEQUATE DRAINAGE OF THE SITE, DURING INTERIM CONDITIONS OF CONSTRUCTION.
- CONTRACTOR SHALL PROVIDE ALL MATERIAL, LABOR, EQUIPMENT, FOR INSTALLATION, IMPLEMENTATION, AND MAINTENANCE OF ALL SURFACE WATER POLLUTION PREVENTION MEASURES THROUGHOUT THE FULL EXTENT OF THE PROJECT. SURFACE WATER IS CLASSIFIED AS ANY BODY OF WATER ABOVE GROUND.
- PAVEMENT MARKINGS DISTURBED, DAMAGED IN ANY FORM, OR TO ANY DEGREE WHILE THE CONTRACTOR HAS CUSTODY OF THE SITE SHALL BE REPLACED IN THEIR ENTIRETY AT CONTRACTOR'S EXPENSE.
- WHERE PARKING IS PERMITTED, THE CONTRACTOR SHALL POST "NO PARKING" SIGNS ON EACH PAVEMENT REHABILITATION STREET AND/OR WORK AREA. THE POSTING SHALL BE VERIFIED BY LAW ENFORCEMENT 72 HOURS PRIOR TO COMMENCING EACH PHASE OF WORK. "NO PARKING" SIGNS WILL BE SUPPLIED BY THE CITY OF SAUSALITO, IF THE INTENDED WORK DOES NOT COMMENCE WITHIN 24 HOURS OF THE SCHEDULED WORK. ALL "NO PARKING" SIGNS SHALL BE REMOVED FROM THE SITE OR AS DIRECTED BY THE ENGINEER AND A REVISED SCHEDULE SHALL BE SUBMITTED FOR REVISION.
- CONTRACTOR TO PROVIDE NOTICE TO PROPERTY OWNERS AND RESIDENTS PRIOR TO MOBILIZATION TO THE SITE. ISSUE ALL ADVANCE NOTICES PER THE REQUIREMENTS IN THE SPECIFICATIONS AND DO NOT HAND OUT NOTIFICATION UNTIL IT IS APPROVED BY THE ENGINEER.
- ALL EXISTING STREET SURFACE FEATURES (MAINTENANCE HOLES, CLEAN-OUTS, MONUMENTS, STRIPING, PAVEMENT MARKINGS, ETC.) SHALL BE REFERENCED BY THE CONTRACTOR PRIOR TO START OF ANY WORK.
- TRAFFIC CONTROL SHALL BE SAFE AND PERFORMED IN ACCORDANCE WITH THE REQUIREMENTS OF THE LATEST "CA MANUAL OF UNIFORM TRAFFIC CONTROL".
- PRIOR TO PERFORMING WORK THAT MAY DAMAGE SURVEY MONUMENTS (DISK, SPIKE, SHINER OR OTHER), CONTRACTOR SHALL OBTAIN CLEARANCE FROM COUNTY SURVEYOR. REPLACE MONUMENT IN ACCORDANCE WITH THE SPECIAL PROVISIONS.

POLLUTION CONTROL NOTES:

- IF SIGNIFICANT SEDIMENT OR OTHER VISUAL SYMPTOMS OF IMPURITIES ARE NOTICED IN THE STORM WATER, CONTACT THE CITY ENGINEER IMMEDIATELY.
- CONTRACTOR IS RESPONSIBLE FOR INSPECTION AND RESTORATION OF ALL ASPECTS OF THIS PLAN. SEDIMENT ON SIDEWALKS AND GUTTERS SHALL BE REMOVED BY SHOVEL AND/OR BROOM AND PLACED IN STOCKPILES.
- ALL DUMPSTERS OR OTHER TRASH STORAGE ENCLOSURES SHALL BE UTILIZED SOLELY FOR NON-HAZARDOUS MATERIALS.
- ALL EMPLOYEES, CONTRACTORS, AND SUBCONTRACTORS ARE RESPONSIBLE FOR CONFORMING TO THE ELEMENTS SHOWN ON THIS PLAN OR RELATED DOCUMENTS.
- THE CONTRACTOR IS RESPONSIBLE FOR OBTAINING ALL PERMITS AND FILING ALL PLANS WITH RELATED AGENCIES ASSOCIATED WITH THEIR WORK. THIS SHALL INCLUDE, BUT NOT BE LIMITED TO, PERMITS FOR STORAGE OF HAZARDOUS MATERIALS, BUSINESS PLANS, PERMITS FOR STORAGE OF FLAMMABLE LIQUIDS, GRADING PERMITS, OR OTHER PLANS OR PERMITS REQUIRED BY MARIN COUNTY, THE CITY OF SAUSALITO, OR OTHER AGENCIES. ALL CONTRACTORS, OR SUBCONTRACTORS WORKING ON-SITE ARE INDIVIDUALLY RESPONSIBLE FOR OBTAINING AND SUBMITTING ANY BUSINESS PLANS OR PERMITS REQUIRED BY CITY, STATE OR LOCAL AGENCIES.
- CONTRACTOR SHALL LOCATE STORAGE, DELIVERY, OR WASH-OUT AREAS, TO SUIT THEIR OPERATIONS. CONTRACTOR TO MAINTAIN SECONDARY CONTAINMENT AS NECESSARY TO PROHIBIT POLLUTION AND TOXIC MATERIALS FROM ENTERING STORM DRAIN.
- CONTRACTOR SHALL UTILIZE SILT FILTERS DURING CONCRETE CONSTRUCTION NEAR EXISTING STORM DRAINAGE SYSTEM. AFTER COMPLETION OF THE PAVING, THE SILT FILTERS SHALL BE MODIFIED TO BURLAP SACKS FILLED WITH 3/4" DRAIN ROCK OR OTHER ACCEPTED BMP POSITIONED SURROUNDING EACH CATCH BASIN.

EROSION CONTROL NOTES:

- NO VEHICLES SHALL BE ALLOWED TO TRACK OR SPREAD SOIL FROM THE CONSTRUCTION AREAS ONTO EXISTING PAVED PUBLIC STREETS.
- THE EROSION AND SEDIMENT CONTROL MEASURES WILL BE OPERABLE FOR DURATION OF PROJECT. NO GRADING WILL OCCUR BETWEEN OCTOBER 1ST AND APRIL 15TH, UNLESS AUTHORIZED BY THE CITY ENGINEER.
- DURING THE RAINY SEASON, ALL PAVED AREAS WILL BE KEPT CLEAR OF EARTH MATERIAL AND DEBRIS. THE SITE WILL BE MAINTAINED SO THAT A MINIMUM OF SEDIMENT-LADEN RUNOFF ENTERS THE STORM DRAIN SYSTEM. THESE PLANS SHALL REMAIN IN EFFECT UNTIL THE TRACT IMPROVEMENTS ARE ACCEPTED BY THE CITY, AND ALL SLOPES ARE STABILIZED FROM EROSION.

URBAN RUNOFF POLLUTION NOTES:

- STABILIZE ALL DENUDEED AREAS AND MAINTAIN EROSION CONTROL MEASURES CONTINUOUSLY FOR THE DURATION OF THE PROJECT.
- REMOVE SPOILS PROMPTLY AND AVOID STOCKPILING OF FILL MATERIALS WHEN RAIN IS FORECAST. IF RAIN THREATENS, STOCK-PILED SOILS AND OTHER MATERIALS SHALL BE TARPED, OR AS OTHERWISE DIRECTED BY CITY ENGINEER.
- STORE, HANDLE AND DISPOSE OF CONSTRUCTION MATERIALS AND WASTES SO AS TO PREVENT THEIR ENTRY TO THE STORM DRAIN SYSTEM. CONTRACTOR MUST NOT ALLOW NON-STORMWATER DISCHARGE TO ENTER SITE RUNOFF.
- USE FILTRATION OR OTHER MEASURES TO REMOVE SEDIMENT FROM DEWATERING EFFLUENT.
- NO CLEANING, FUELING OR MAINTAINING VEHICLES ON SITE SHALL BE PERMITTED IN ANY MANNER THAT ALLOWS DELETERIOUS MATERIALS TO ENTER CATCH BASINS OR TO ENTER SITE RUNOFF.
- CONTRACTOR TO RELOCATE CONCRETE WASHDOWN, VEHICLE STORAGE DELIVERY, AND NON HAZARDOUS WASTE AREAS AS NECESSARY TO FACILITATE THEIR OPERATION, PROMOTE POLLUTION CONTROL AND TO MINIMIZE PROJECT FOOTPRINT.

PRESERVATION OF SURVEY MONUMENTS

CONTRACTOR SHALL PRESERVE ALL SURVEY MONUMENTS WITHIN THE LIMITS OF WORK. MONUMENT(S) WITHIN THE LIMITS OF WORK SHALL BE REFERENCED, PRIOR TO WORK COMMENCING, BY A LICENSED LAND SURVEYOR AS REQUIRED BY SECTION 8771 OF THE BUSINESS AND PROFESSIONS CODE. CORNER RECORDS OF THIS WORK MUST BE SUBMITTED FOR FILING TO THE COUNTY SURVEYOR OF MARIN COUNTY PUBLIC WORKS DEPARTMENT, ENGINEERING DIVISION, SURVEY SECTION.

THE CONTRACTOR SHALL BE RESPONSIBLE FOR THE PRESERVATION OF EXISTING SURVEY MONUMENTS, BENCHMARKS, REFERENCE MARKS AND STAKES. SHOULD ANY SURVEY MONUMENTS, BENCHMARKS, REFERENCE POINTS, OR STAKES BE DAMAGED OR DESTROYED DURING THE PERFORMANCE OF THIS WORK, THE CONTRACTOR SHALL REPLACE SAID ITEMS PER CITY CONSTRUCTION STANDARDS IN ACCORDANCE WITH THE SPECIAL PROVISIONS AND CONTACT THE COUNTY, SURVEY SECTION, CHIEF OF PARTY FOR FINAL INSPECTION AND ACCEPTANCE OF THE WORK.

SURVEY NOTES

- DISTANCES SHOWN ARE IN FEET AND DECIMALS THEREOF.
- FIELD SURVEY WAS PERFORMED USING GPS EQUIPMENT TO ESTABLISH CONTROL AND CONVENTIONAL METHODS (TOTAL STATIONS) AT RAMP AND INTERSECTION LOCATIONS.
- CONTROL ESTABLISHED BY CALIFORNIA REAL TIME NETWORK (CRTN). HORIZONTAL DATUM IS CALIFORNIA STATE PLANE COORDINATES, NORTH AMERICAN DATUM OF 1983 (NAD83), ZONE 3, EPOCH 2015.5. VERTICAL DATUM IS NORTH AMERICAN VERTICAL DATUM OF 1988 PER CRTN.
- FIELD SURVEYS WERE PERFORMED IN APRIL OF 2022 BY CSW/STUBER-STROEH ENGINEERING GROUP, INC. FOR ANY INQUIRIES, PLEASE CONTACT JOSH WOELBING, PLS AT JOSHW@CSWST2.COM (707) 479-5112.

PROJECT STANDARD PLANS

CALTRANS STANDARD PLANS, 2018

A24F PAVEMENT MARKINGS

UNIFORM CONSTRUCTION STANDARDS (UCS) OF THE CITIES OF MARIN AND COUNTY OF MARIN, JULY 2018

UCS DWG. NO. 100 REQUIREMENTS FOR CONCRETE CURB, GUTTER, SIDEWALK, DRIVEWAY, AND OTHER "FLATWORK"
UCS DWG. NO. 105 CURB, GUTTER AND SIDEWALK DETAILS

SURVEY CONTROL POINTS

| POINT NO. | NORTHING | EASTING | ELEVATION | DESCRIPTION |
|-----------|-----------|-----------|-----------|----------------------|
| 1 | 5000.0000 | 5000.0000 | 200.00 | CP TACK WD RNR |
| 2 | 5187.9490 | 5061.0690 | 191.04 | CP MN GTR |
| 3 | 5012.7230 | 5016.3190 | 198.54 | FND MON 2"BDWP |
| 4 | 4832.8660 | 5010.3460 | 207.06 | FND MON 2"BDWP |
| 5 | 4870.3890 | 4992.3410 | 204.16 | CP MNW PLS 7053 |
| 6 | 4845.7940 | 4983.3140 | 205.03 | CP TACK DW CNC APRON |
| 7 | 5321.5460 | 5099.6160 | 175.21 | CP MN CNC ROAD |
| 8 | 5212.3460 | 5057.6810 | 189.94 | CP MNW PLS 7053 |
| 9 | 5485.6930 | 5187.0030 | 141.53 | CP MNW PLS 7053 |
| 10 | 5382.1510 | 5129.1390 | 162.26 | CP MN |
| 11 | 5187.9470 | 5061.0800 | 191.04 | CK 7-2 |
| 12 | 5315.3350 | 5084.0580 | 178.14 | FND NT LS 8494 |
| 13 | 5540.3670 | 5279.3310 | 117.51 | CP MN @TC |
| 14 | 5572.4050 | 5293.3080 | 110.48 | CP MN WALK CNC |
| 15 | 5636.2700 | 5378.5600 | 90.23 | CP MN DW CNC |

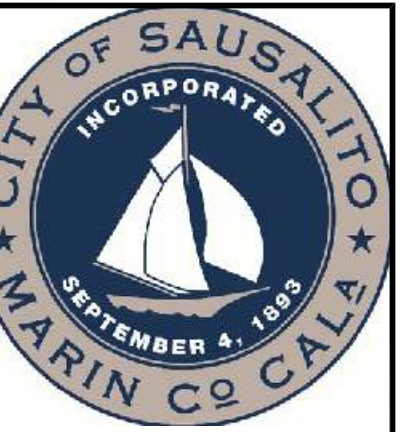

CSW | ST 2

CSW/Stuber-Stroeh Engineering Group, Inc.

504 Redwood Blvd
Novato, CA 94947
tel: 415.883.9850
fax: 415.883.9835

Civil Engineers
Surveying & Mapping
Land Planning
Construction Management

| Rev | Date | Description | Designed | Drawn | Checked |
|-----|----------|-------------|----------|-------|---------|
| A | 09/20/23 | | | | |

STREET REHABILITATION
GENERAL NOTES,
ABBREVIATIONS, & SYMBOLS
SAUSALITO, CALIFORNIA

City Of
Sausalito

County Of
Marin

State Of
California

Prepared Under the Direction of:

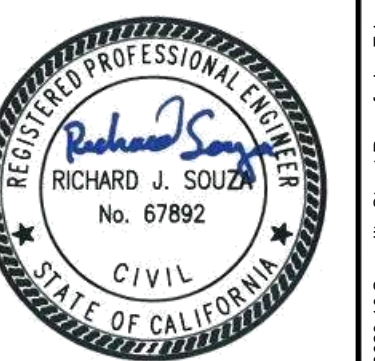

Sheet

C1.01

Scale: N.T.S.

Date: September 20, 2023

Sheet Number: 2 OF 11

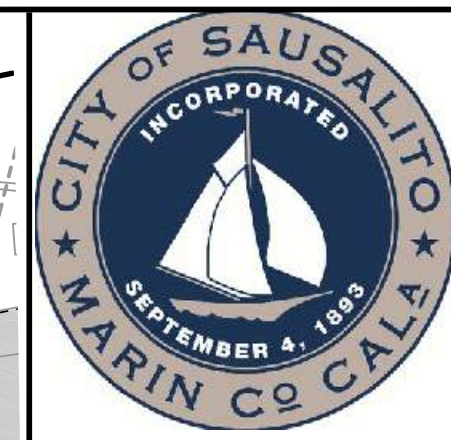

CSW | ST 2
CSW/Stuber-Stroeh Engineering Group, Inc.
 504 Redwood Blvd
 Novato, CA 94947
 tel: 415.883.9850
 fax: 415.883.9835
 Civil Engineers
 Surveying & Mapping
 Land Planning
 Construction Management

| Rev | Date | Description | Designed | Drawn | Checked |
|-----|----------|-------------|----------|-------|---------|
| A | 09/20/23 | BID SET | RJS | IP | RJS |

STREET REHABILITATION PAVEMENT PLAN (STA 1+15 to 4+20) SAUSALITO, CALIFORNIA

City of Sausalito
 County of Marin
 State of California

Prepared Under the Direction of:



Sheet **C2.00**
 Scale: 1" = 10'
 Date: September 20, 2023
 Sheet Number: 3 OF 11

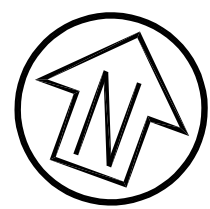

Graphic Scale (in feet)
 1 inch = 10 ft

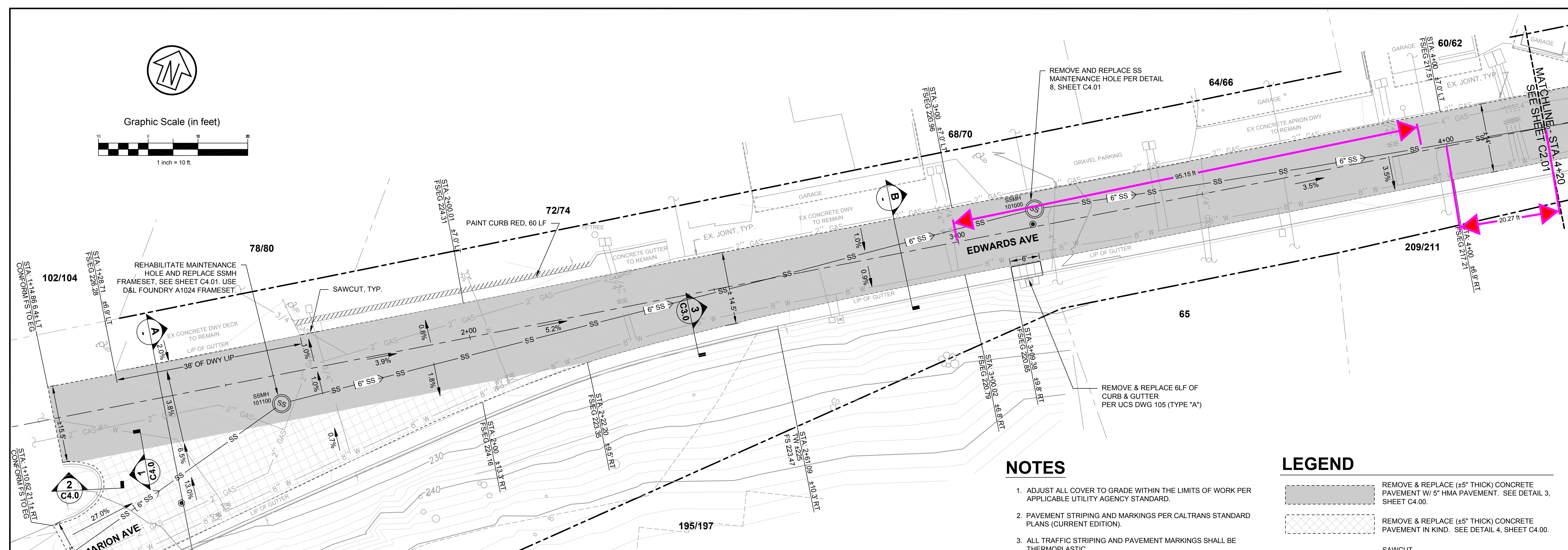

NOTES

1. ADJUST ALL COVER TO GRADE WITHIN THE LIMITS OF WORK PER APPLICABLE UTILITY AGENCY STANDARD.
2. PAVEMENT STRIPING AND MARKINGS PER CALTRANS STANDARD PLANS (CURRENT EDITION).
3. ALL TRAFFIC STRIPING AND PAVEMENT MARKINGS SHALL BE THERMOPLASTIC.

LEGEND

- [Hatched pattern] REMOVE & REPLACE (4.5" THICK) CONCRETE PAVEMENT W/ 5" HMA PAVEMENT. SEE DETAIL 3, SHEET C4.00.
- [Cross-hatched pattern] REMOVE & REPLACE (4.5" THICK) CONCRETE PAVEMENT IN KIND. SEE DETAIL 4, SHEET C4.00.
- [Dashed line] SAWCUT

PLAN VIEW (STA 1+15 to 4+20)

SCALE: 1" = 10'

NOTE:
 APPLY TACK COAT ON EX. AC AND CONCRETE SURFACES

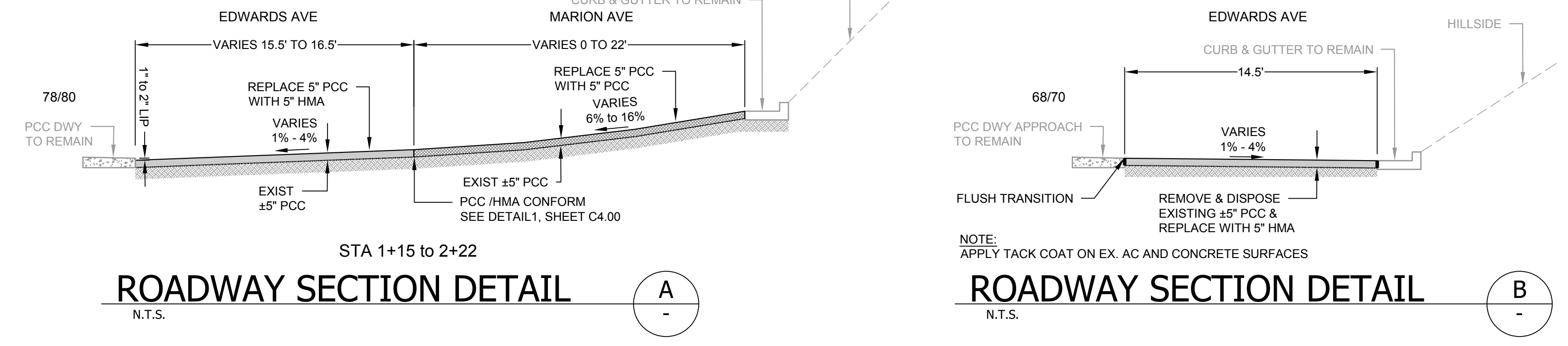

REMOVE, DISPOSE, AND REPLACE EXISTING 5" PCC PAVEMENT WITH 5" HMA PAVEMENT

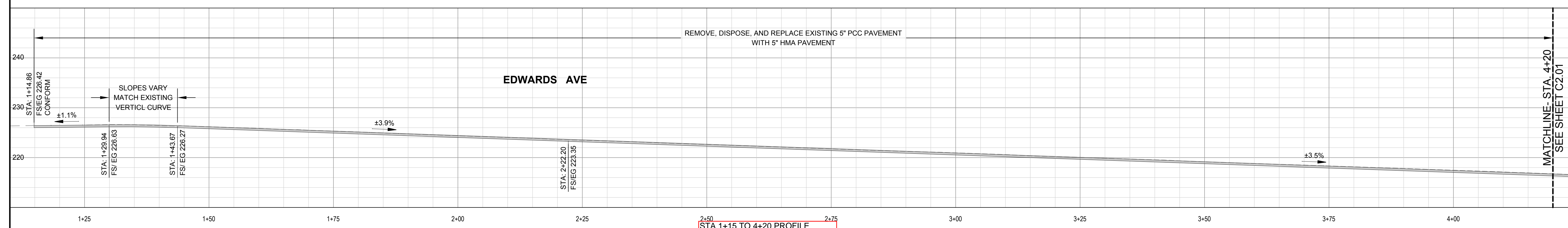

PROFILE VIEW

SCALE: 1" = 10'

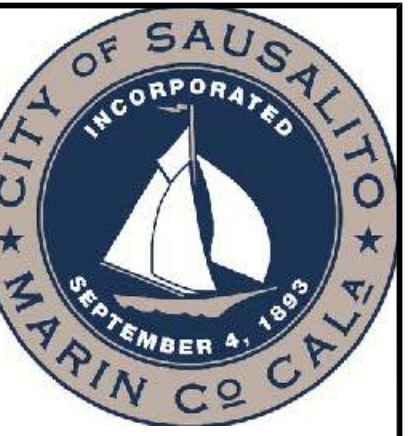

CSW | ST 2

CSW/Stuber-Stroeh Engineering Group, Inc.

504 Redwood Blvd Novato, CA 94947 tel: 415.883.9850 fax: 415.883.9835

Civil Engineers Surveying & Mapping Land Planning Construction Management

| Rev | Date | Description | IP | RJS |
|-----|----------|-------------|----|-----|
| A | 09/20/23 | BID SET | | |

STREET REHABILITATION PAVEMENT PLAN (STA 4+20 to 7+30) SAUSALITO, CALIFORNIA

City of Sausalito County of Marin State of California

Prepared Under the Direction of:

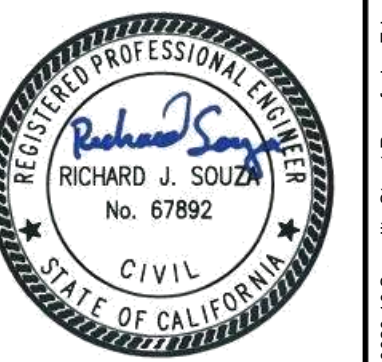

Sheet

C2.01

Scale: 1" = 10'

Date: September 20, 2023

Sheet Number: 4 OF 11

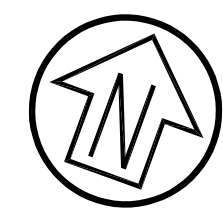

Graphic Scale (in feet)

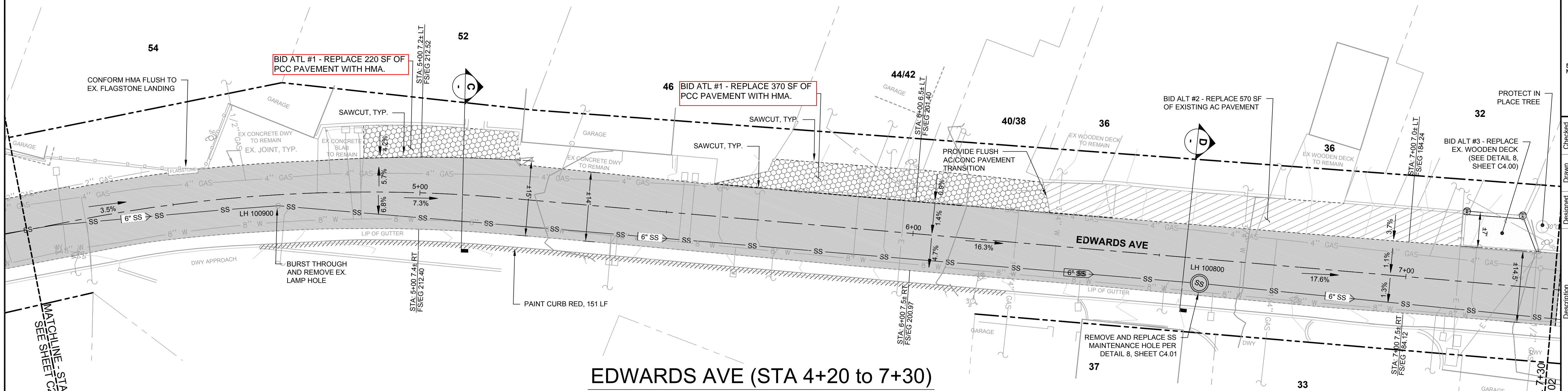
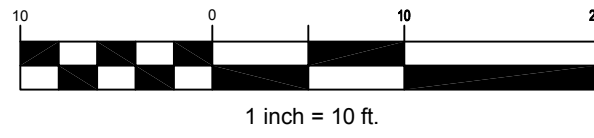

EDWARDS AVE (STA 4+20 to 7+30)

SCALE: 1" = 10'

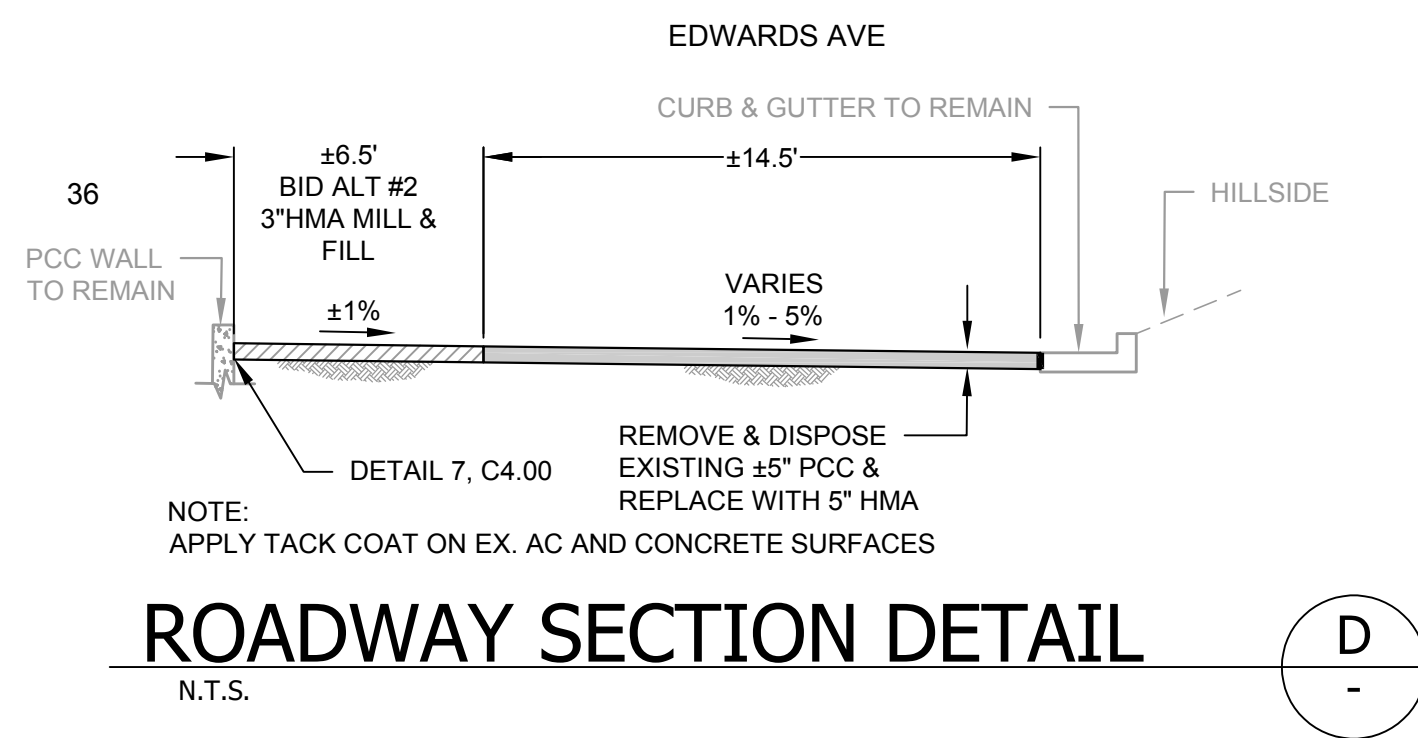
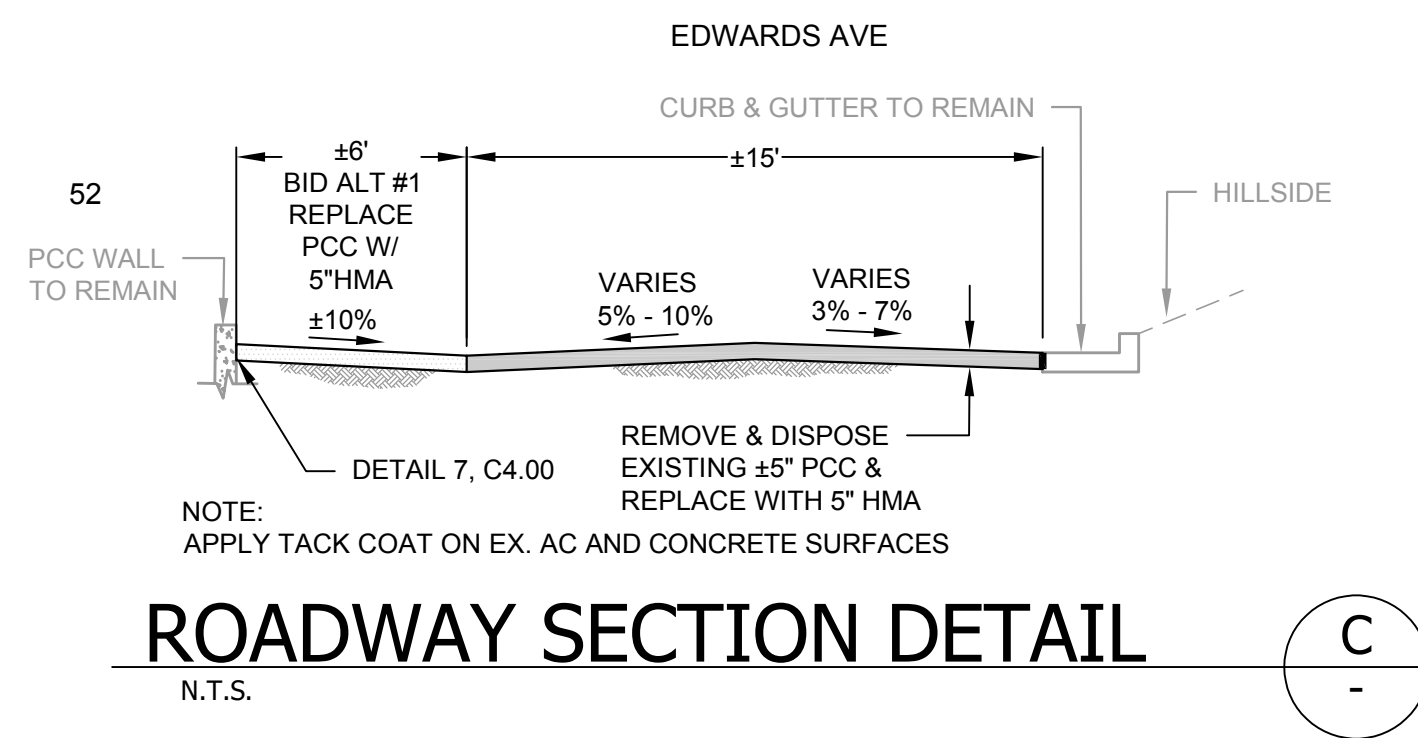

LEGEND

- REMOVE & REPLACE (±5" THICK) CONCRETE PAVEMENT W/ 5" HMA PAVEMENT. SEE DETAIL 3, SHEET C4.00.
- REMOVE & REPLACE (±5" THICK) CONCRETE PAVEMENT IN KIND. SEE DETAIL 4, SHEET C4.00.
- BID ALT #1 - REMOVE & REPLACE (±5" THICK) CONCRETE PAVEMENT WITH (±5" THICK) HMA. SEE DETAIL 3 SHEET C4.00
- BID ALT #2 - MILL & FILL AC PAVEMENT (3" HMA)
- BID ALT #3 - REPLACE EX. WOODEN DECK (SEE DETAIL 8, SHEET C4.00)
- SAWCUT

NOTES

- ADJUST ALL COVER TO GRADE WITHIN THE LIMITS OF WORK PER APPLICABLE UTILITY AGENCY STANDARD.

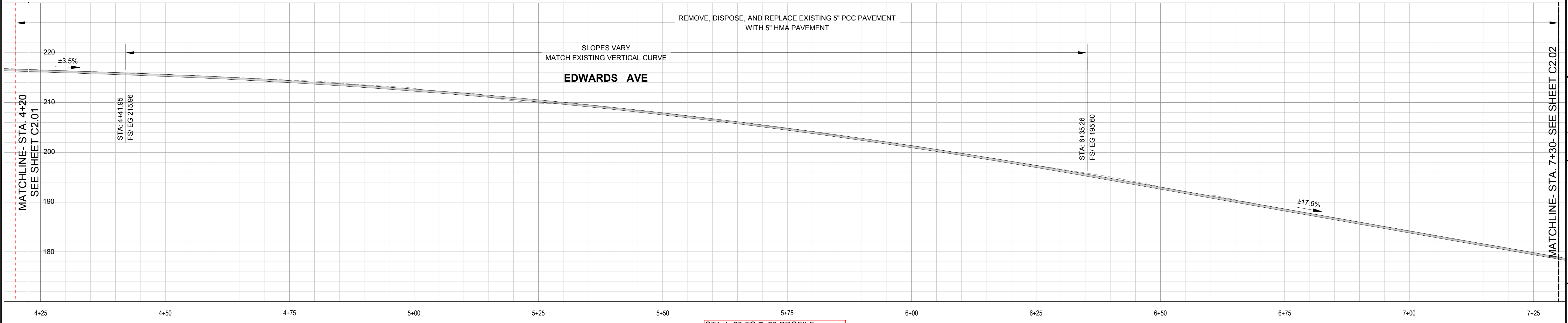

PROFILE VIEW

SCALE: 1" = 10'

STA 4+20 TO 7+30 PROFILE

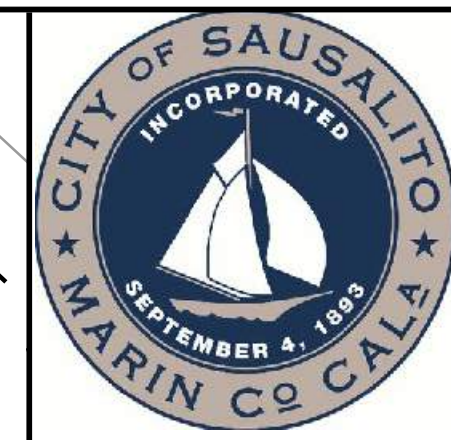

CSW | ST 2

CSW/Stuber-Stroeh Engineering Group, Inc.

504 Redwood Blvd
Novato, CA 94947
tel: 415.883.9650
fax: 415.883.9635

Civil Engineers
Surveying & Mapping
Land Planning
Construction Management

| Rev | Date | Description | Designed | Drawn | Checked | RJS | IP | RJS |
|-----|----------|-------------|----------|-------|---------|-----|----|-----|
| A | 09/20/23 | BID SET | | | | | | |

STREET REHABILITATION PAVEMENT PLAN (STA 7+30 to 10+35) SAUSALITO, CALIFORNIA

City of Sausalito
County of Marin
State of California

Prepared Under the Direction of:



Sheet **C2.02**
Scale: 1" = 10'
Date: September 20, 2023
Sheet Number: 5 OF 11

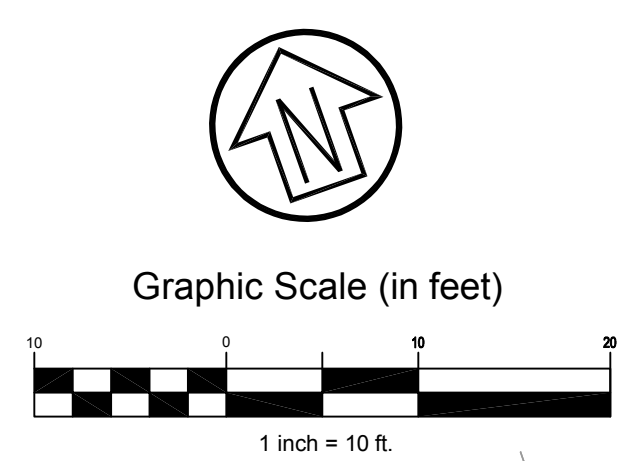
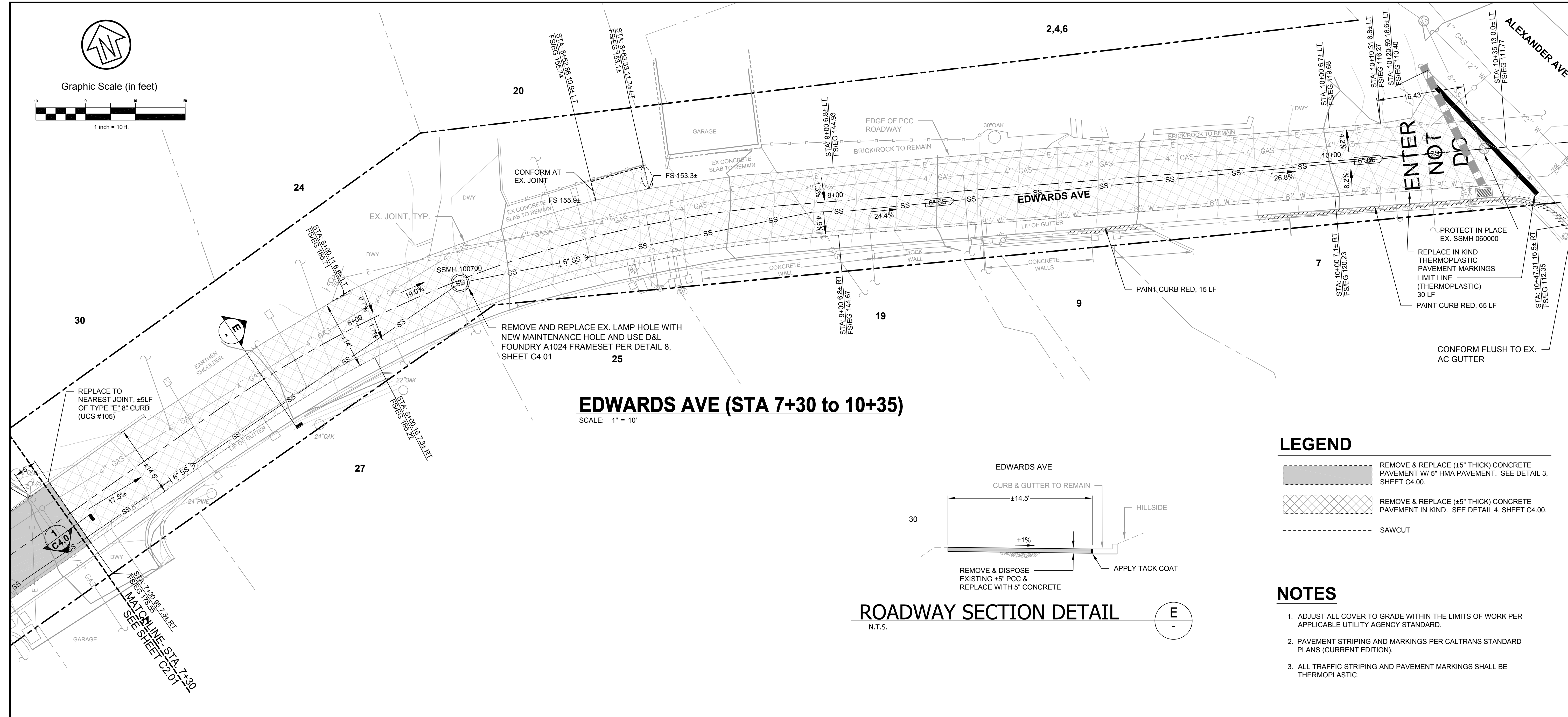

EDWARDS AVE (STA 7+30 to 10+35)
SCALE: 1" = 10'

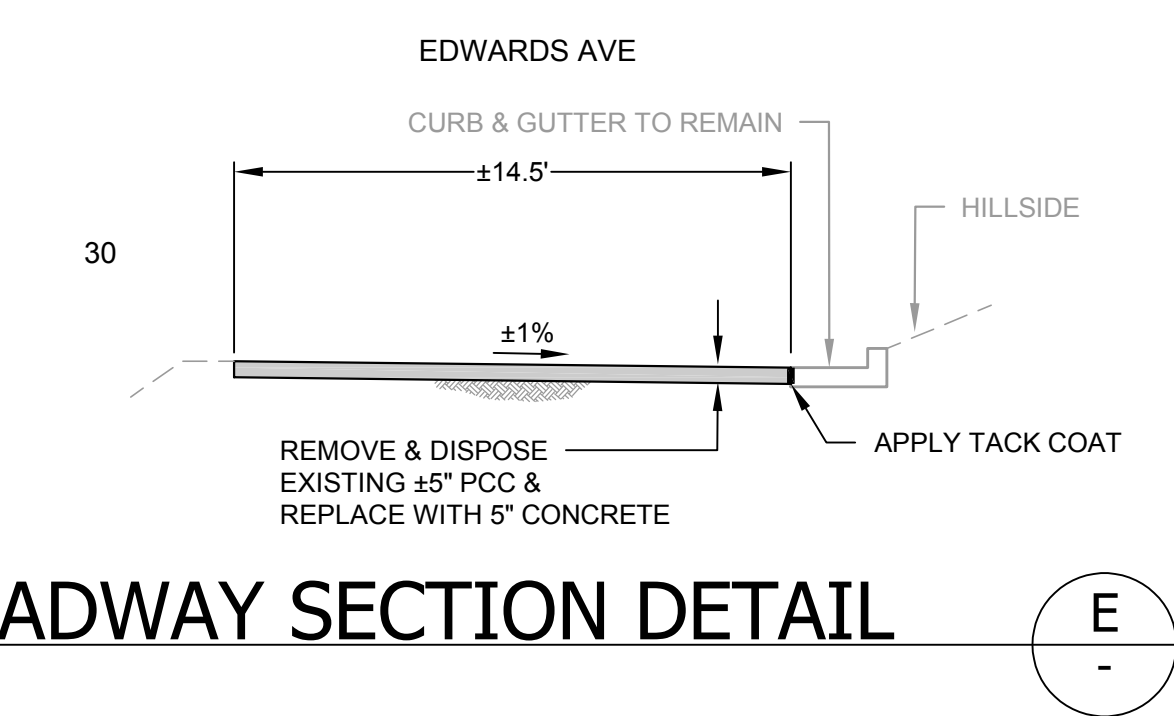

LEGEND

- [Hatched Pattern] REMOVE & REPLACE (±5" THICK) CONCRETE PAVEMENT W/ 5" HMA PAVEMENT. SEE DETAIL 3, SHEET C4.00.
- [Dashed Line] REMOVE & REPLACE (±5" THICK) CONCRETE PAVEMENT IN KIND. SEE DETAIL 4, SHEET C4.00.
- [Dotted Line] SAWCUT

- NOTES**
- ADJUST ALL COVER TO GRADE WITHIN THE LIMITS OF WORK PER APPLICABLE UTILITY AGENCY STANDARD.
 - PAVEMENT STRIPING AND MARKINGS PER CALTRANS STANDARD PLANS (CURRENT EDITION).
 - ALL TRAFFIC STRIPING AND PAVEMENT MARKINGS SHALL BE THERMOPLASTIC.

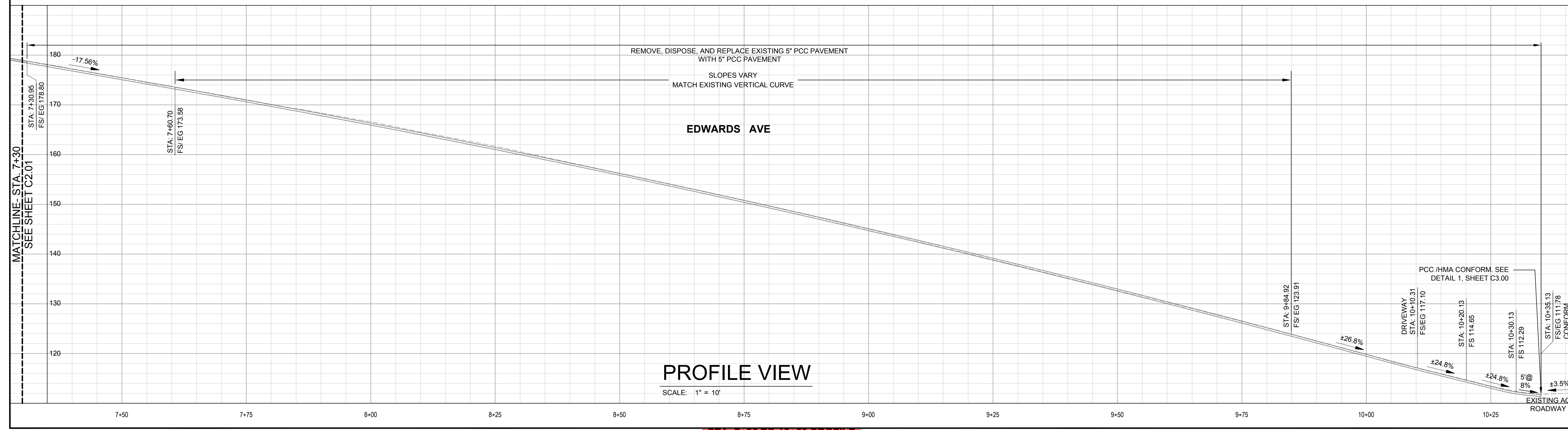

PROFILE VIEW
SCALE: 1" = 10'

STA 7+30 TO 10+50 PROFILE

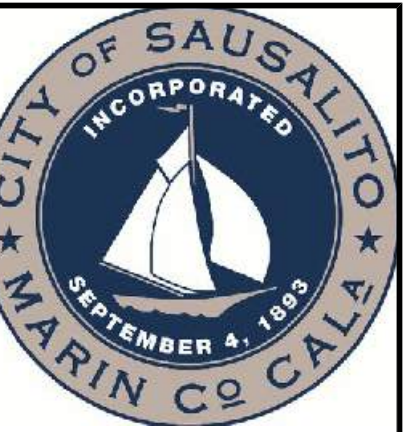

CSW | ST 2

CSW/Stuber-Stroeh Engineering Group, Inc.

504 Redwood Blvd Novato, CA 94947 tel: 415.883.9850 fax: 415.883.9835

Civil Engineers
Surveying & Mapping
Land Planning
Construction Management

| Rev | Date | Description | Designed | Drawn | Checked |
|-----|----------|-------------|----------|-------|---------|
| A | 09/20/23 | BID SET | RJS | IP | RJS |

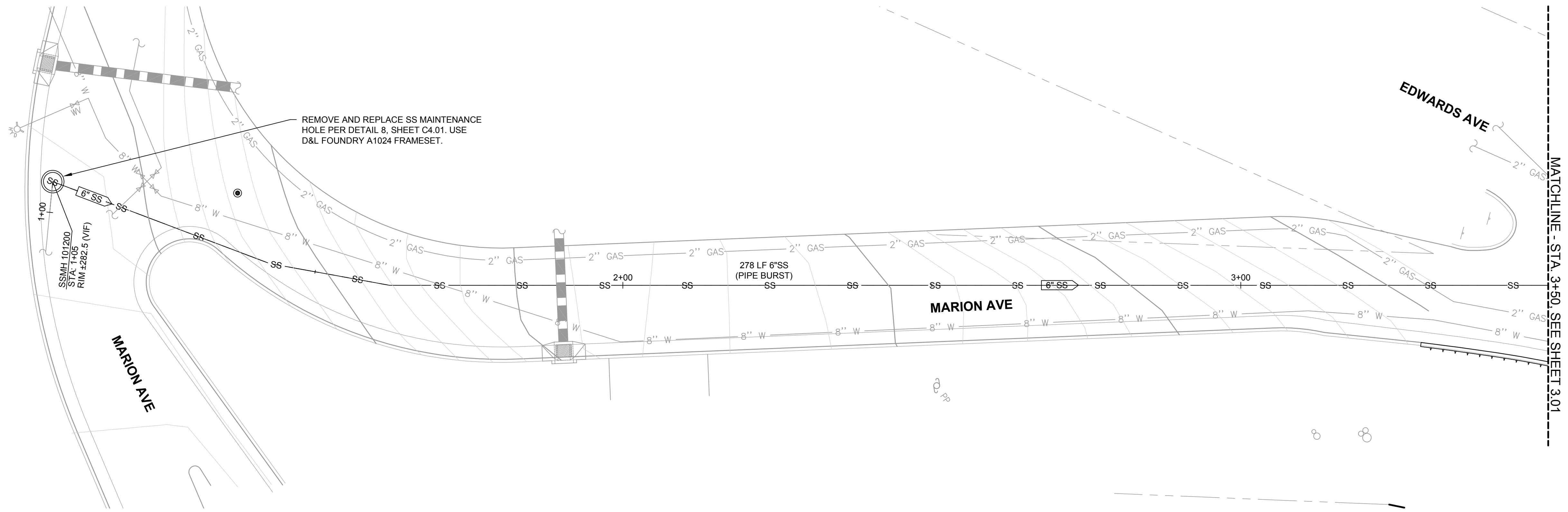

PLAN VIEW (STA 1+00 to 3+50)

SCALE: 1" = 10'

LEGEND

SSCO. SEE DETAIL 6, SHEET C4.01

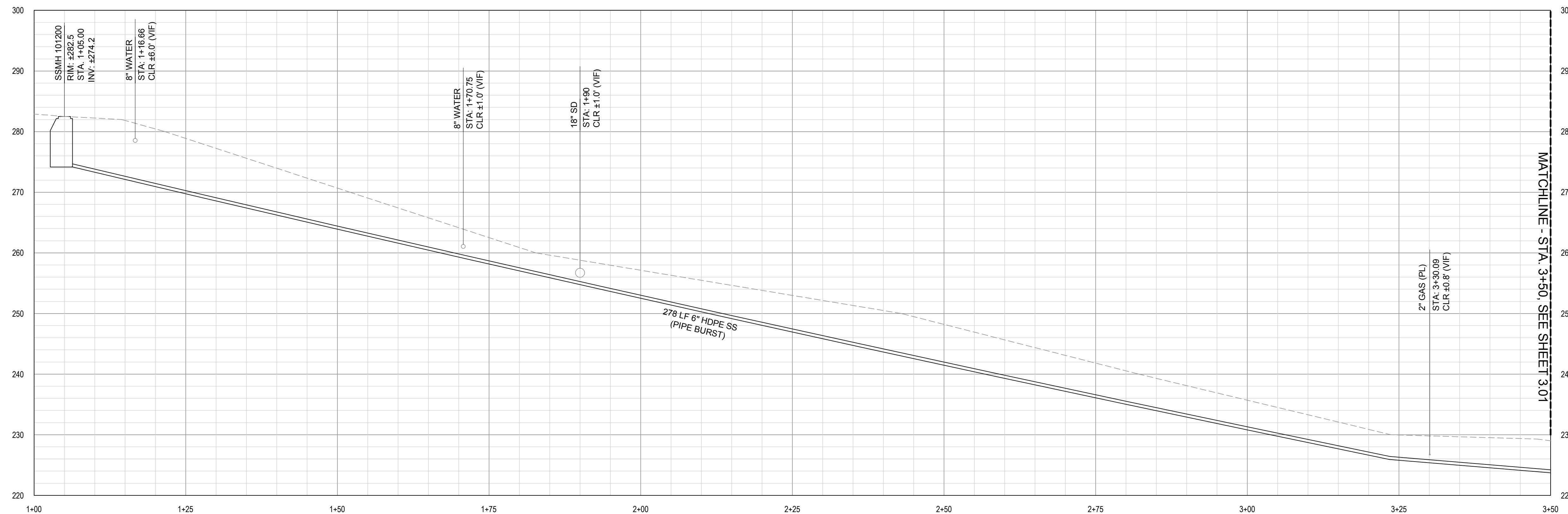
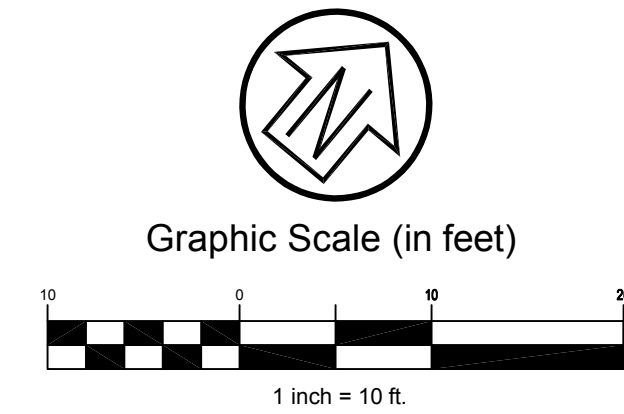

SEWER PROFILE- STA. 1+00 TO 3+50

SCALE: HOR. 1" = 10' VERT. 1" = 10'

**STREET REHABILITATION
SEWER PLAN
(STA 1+00 TO 3+50)
SAUSALITO, CALIFORNIA**

City Of
Sausalito
County Of
Marin
State Of
California

Prepared Under the Direction of:

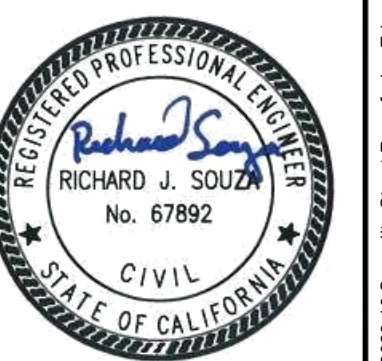

Sheet
C3.00

Scale: 1" = 10'
Date: September 20, 2023
Sheet Number: 6 OF 11

V:\proj\Drawings\Sheet\Project\2022\20230910_Sausalito_Street_Rehab_Sewer\GIS\Sheet\3.00_SEWER_PLAN.dwg 09/20/2023 - 02:36 PM user: 1315692

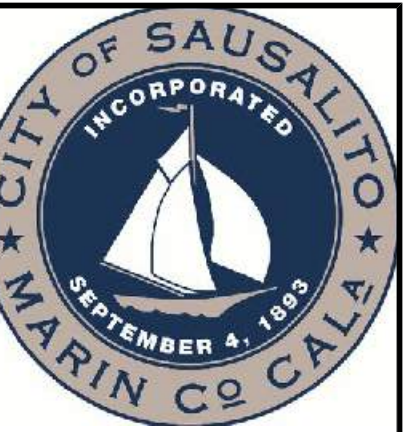

CSW | ST 2

CSW/Stuber-Stroeh Engineering Group, Inc.

504 Redwood Blvd
Novato, CA 94947

tel: 415.883.9850
fax: 415.883.9835

Civil Engineers
Surveying & Mapping
Land Planning
Construction Management

| Rev | Date | Description | Designed | Drawn | Checked |
|-----|----------|-------------|----------|-------|---------|
| A | 09/20/23 | BID SET | RJS | IP | RJS |

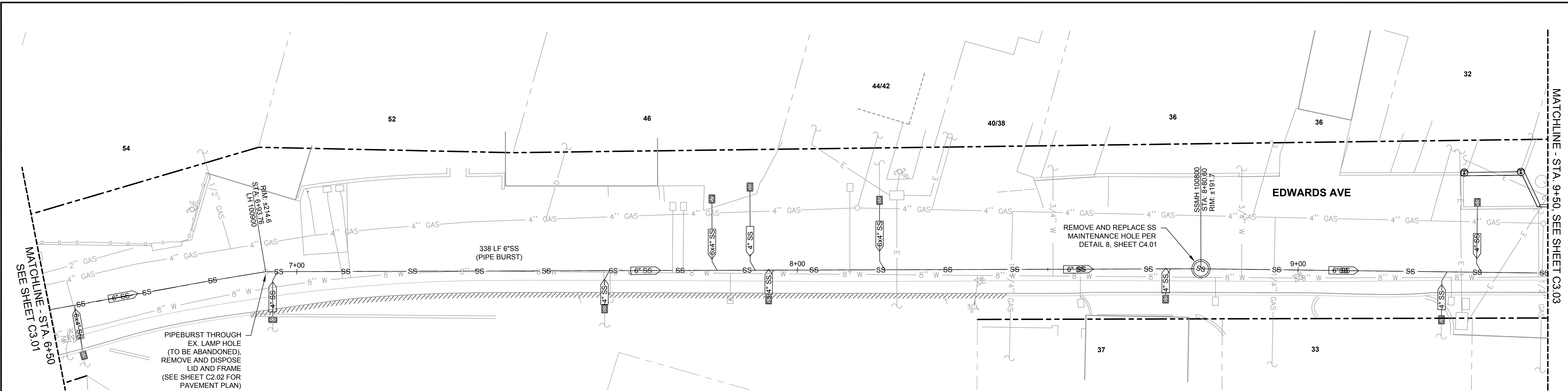

PLAN VIEW (STA 6+50 to 9+50)

SCALE: 1" = 10'

LEGEND

SSCO. SEE DETAIL 6, SHEET C4.01

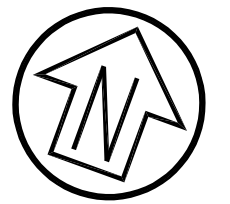

Graphic Scale (in feet)

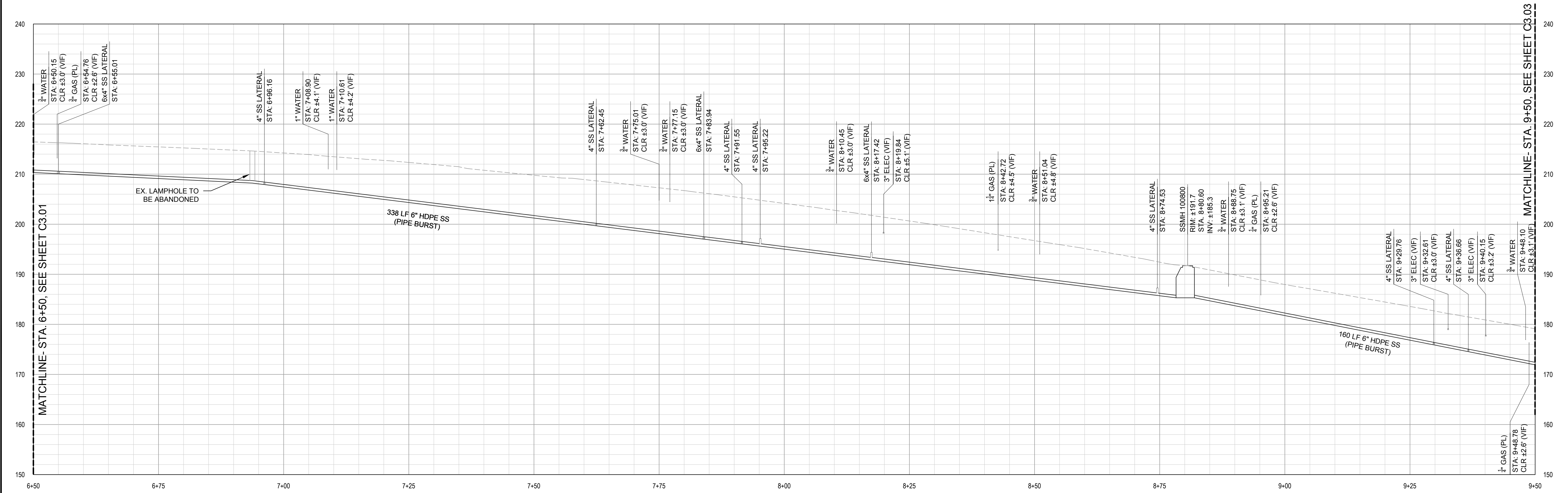
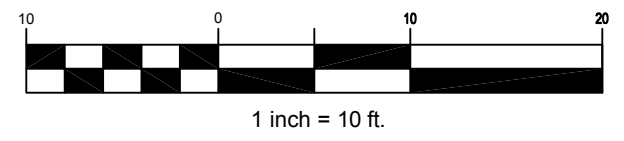

SEWER PROFILE- STA. 6+50 TO 9+50

SCALE: HOR. 1" = 10' VERT. 1" = 10'

**STREET REHABILITATION
SEWER PLAN
(STA 6+50 TO 9+50)
SAUSALITO, CALIFORNIA**

City of
Sausalito
County Of
Marin
State Of
California

Prepared Under the Direction of:

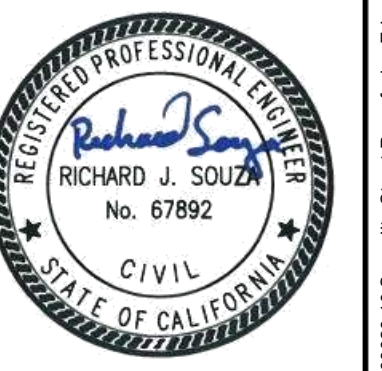

Sheet
C3.02

Scale: 1" = 10'

Date: September 20, 2023

Sheet Number: 8 OF 11

W:\proj\Drawings\Sheet\proj\2022\2023010_10_Sausalito_Street_Rehabilitation_Edwards\GIS\Sheet\C3.02_SEWER PLAN.dwg 09/20/2023 12:57 PM user:131592

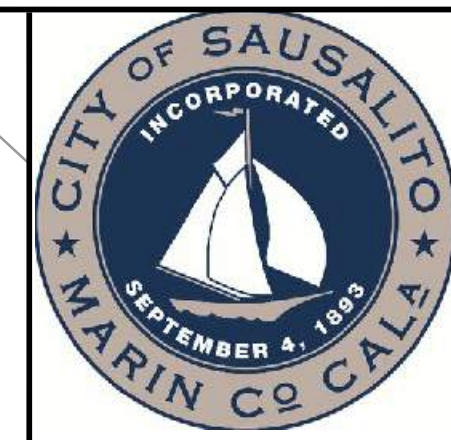

CSW | ST 2

CSW/Stuber-Stroeh Engineering Group, Inc.

504 Redwood Blvd
Novato, CA 94947
tel: 415.883.9850
fax: 415.883.9835

Civil Engineers
Surveying & Mapping
Land Planning
Construction Management

| Rev | Date | Description | Designed | Drawn | Checked |
|-----|----------|-------------|----------|-------|---------|
| A | 09/20/23 | BID SET | RJS | IP | RJS |

**STREET REHABILITATION
SEWER PLAN
(STA 9+50 TO 12+55)
SAUSALITO, CALIFORNIA**

City Of
Sausalito
County Of
Marin
State Of
California

Prepared Under the Direction of:



Sheet
C3.03
Scale: 1" = 10'
Date: September 20, 2023
Sheet Number: 9 OF 11

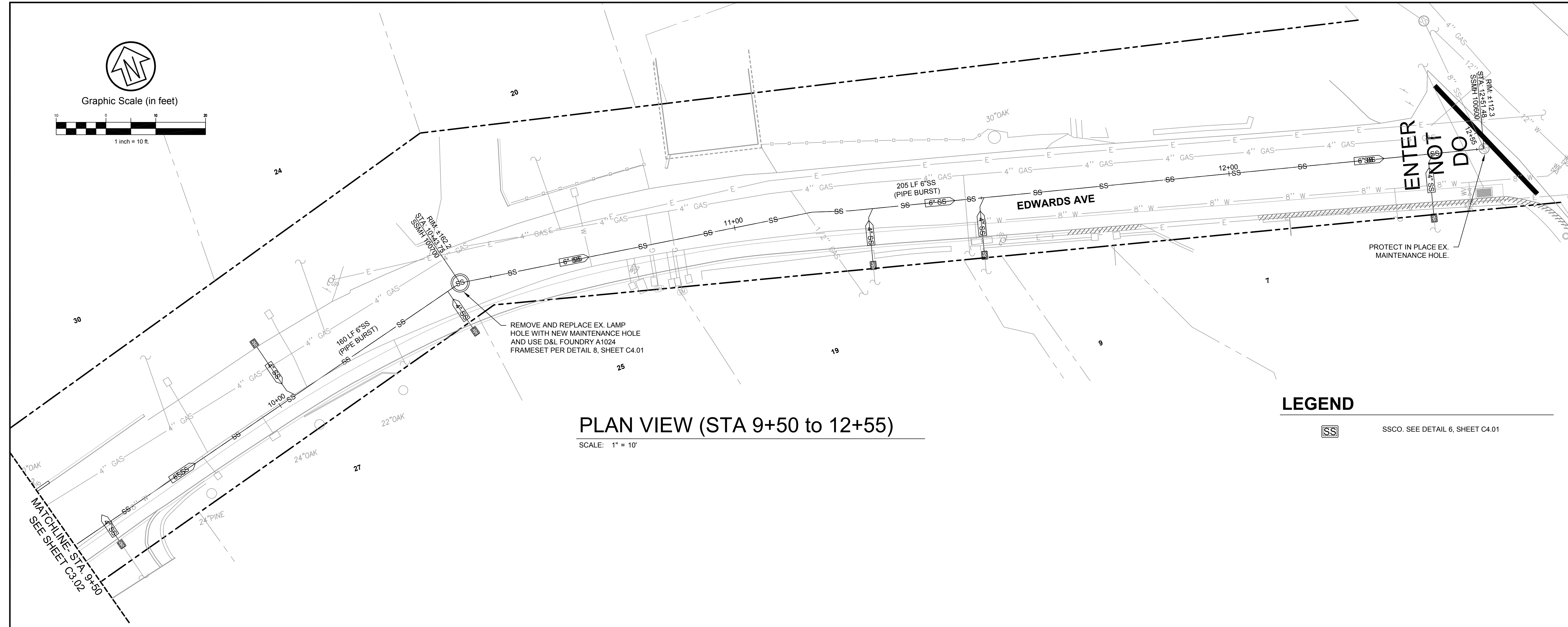
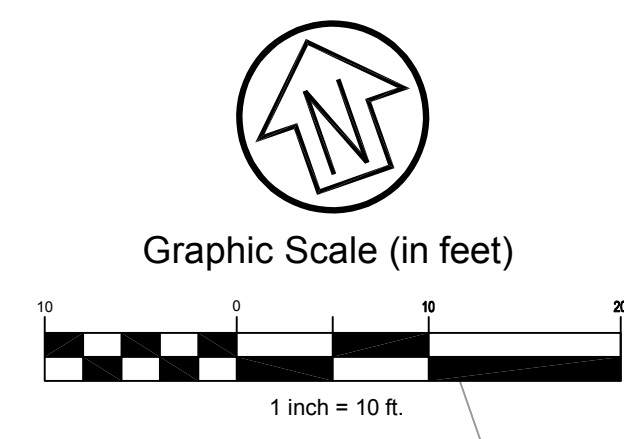

PLAN VIEW (STA 9+50 to 12+55)
SCALE: 1" = 10'

LEGEND

SS SSCO. SEE DETAIL 6, SHEET C4.01

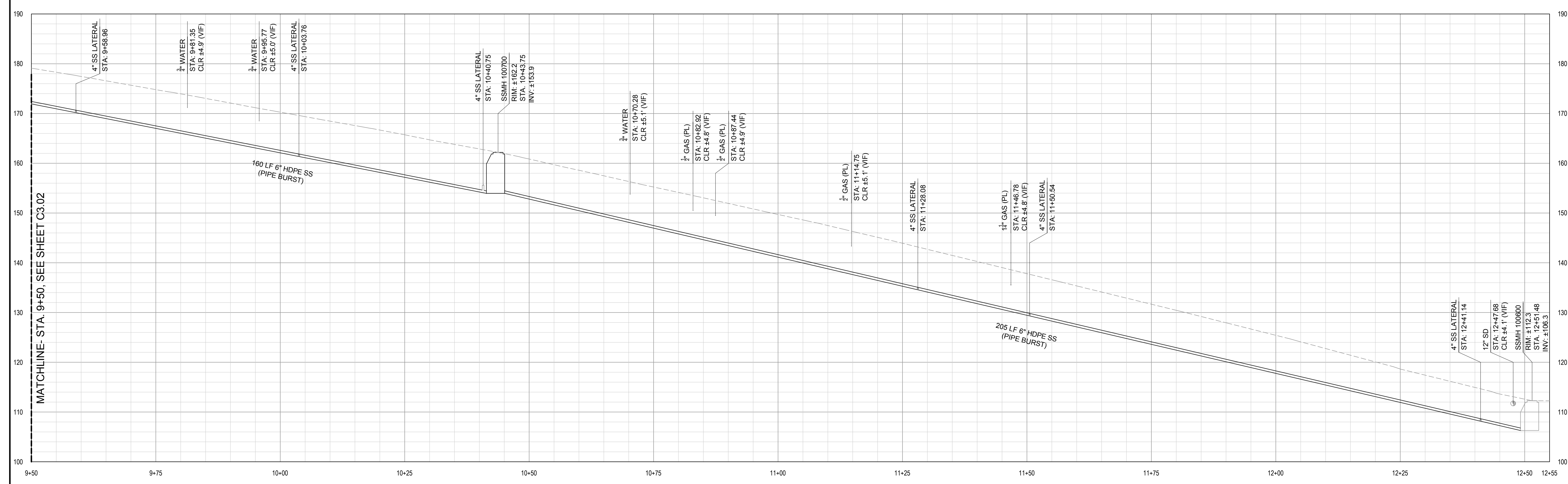

SEWER PROFILE- STA. 9+50 TO 12+55
SCALE: HOR: 1" = 10' VERT: 1" = 10'

\\proj01\Drawings\Sheet\Projects\2022\20000_10_Sausalito_Street_Rehabilitation_Edwards\DWG\Sheet\C3.03_SEWER_PLAN.dwg 09/20/2023 - 02:39 PM, user: 13.5922

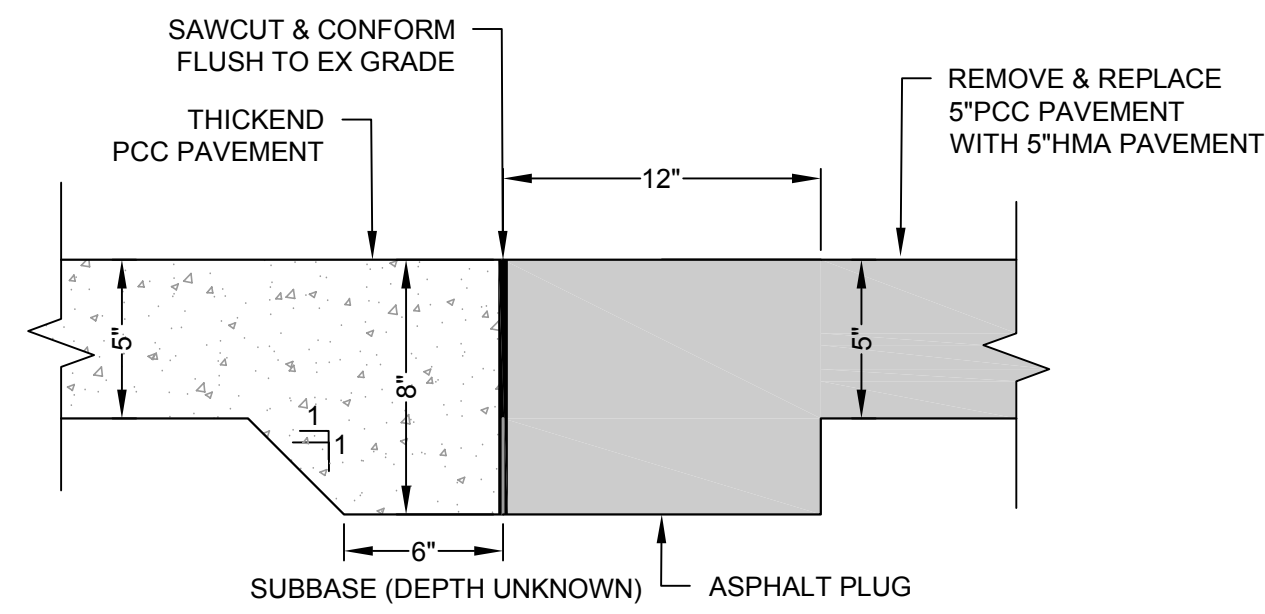

- NOTE:**
1. APPLY TACK COAT ON EX PAVEMENT SURFACES
 2. PROTECT IN PLACE EX SUBBASE

1 HMA/PCC CONFORM DETAIL
SCALE: NTS

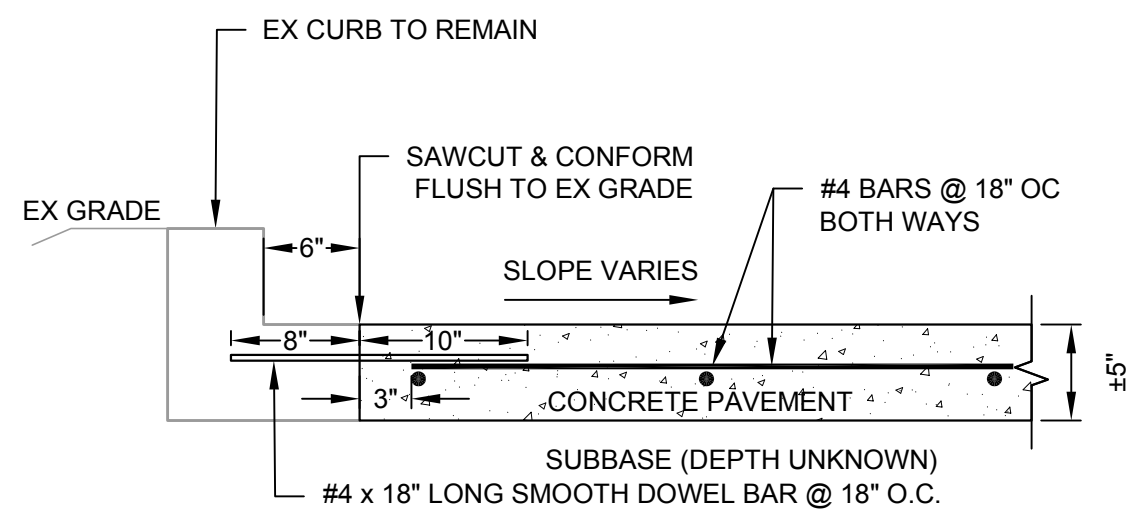

- NOTE:**
1. PROVIDE DOWEL CAP IN NEW CONCRETE END TO ALLOW MOVEMENT IN JOINT
 2. PROTECT IN PLACE EX SUBBASE

2 GUTTER/ PCC CONFORM DETAIL
SCALE: NTS

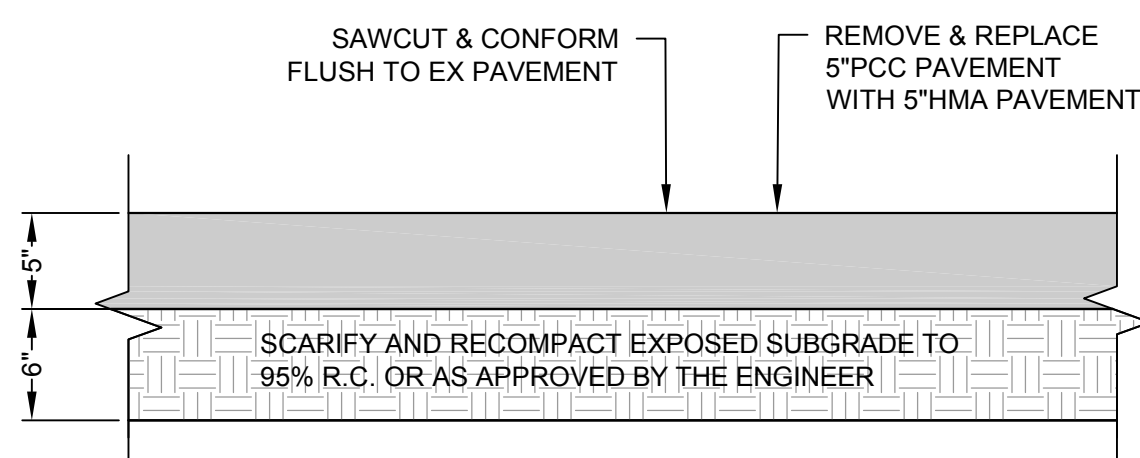

- NOTE:**
1. REMOVE & DISPOSE 45" OF EXISTING PCC PAVEMENT
 2. PROVIDE 45" OF HMA IN (2) LIFTS TO MATCH EXISTING GRADES. BOTTOM LIFT SHALL BE 3" THICK
 3. AS APPLICABLE, REUSE OF EXISTING BASEROCK SHALL BE APPROVED BY THE ENGINEER.
 4. PROTECT IN PLACE EX SUBBASE

3 HMA PAVEMENT DETAIL
SCALE: NTS

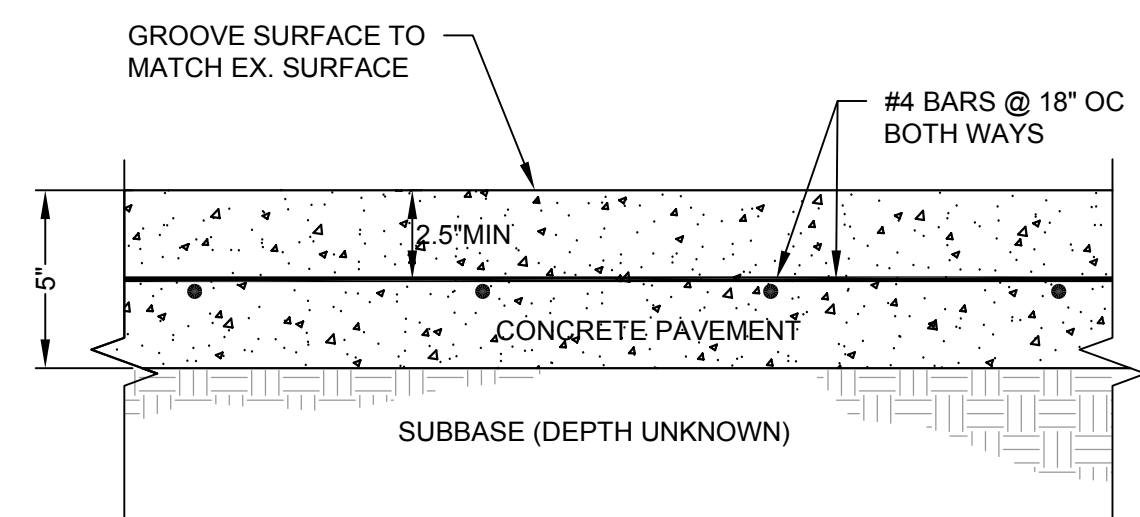

- NOTE:**
1. REMOVE & DISPOSE 45" OF EXISTING PCC PAVEMENT
 2. AS APPLICABLE, REUSE OF EXISTING BASEROCK SHALL BE APPROVED BY THE ENGINEER.
 3. 2.5" REBAR CLEAR OVERALL

4 NEW PCC PAVEMENT DETAIL
SCALE: NTS

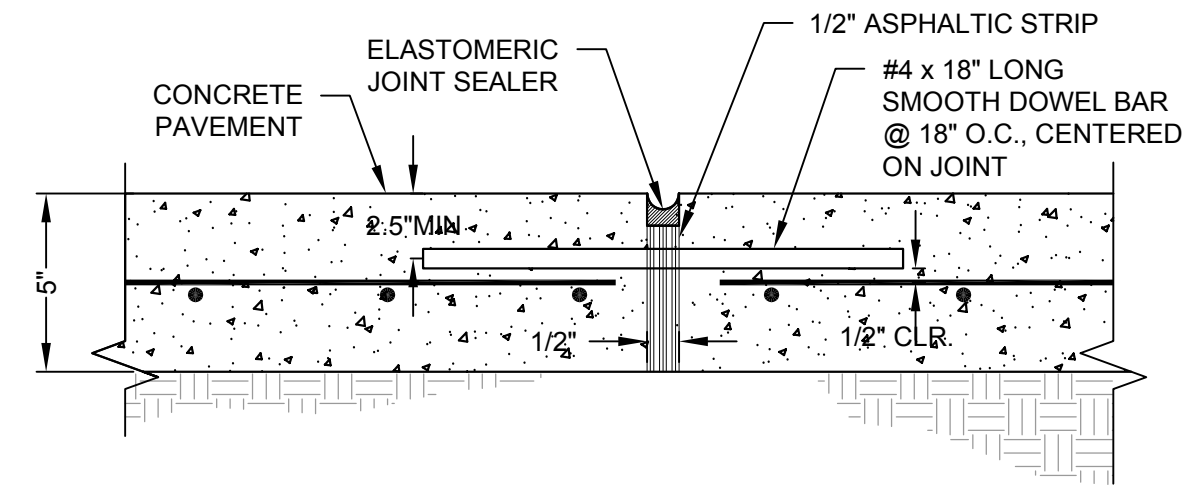

- NOTE:**
1. EXPANSION JOINTS TO BE INSTALLED AT 16' ON-CENTER.
 2. PROVIDE DOWEL CAP IN NEW CONCRETE END TO ALLOW MOVEMENT IN JOINT.

5 EXPANSION JOINT DETAIL
SCALE: NTS

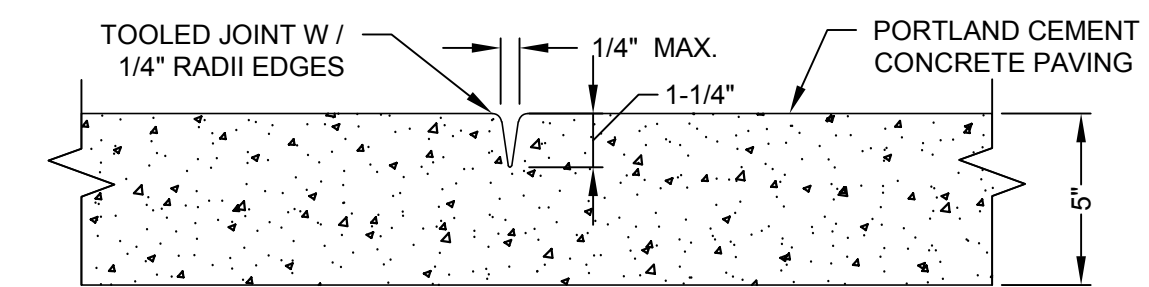

- NOTES:**
1. CONTROL JOINTS SHALL BE CONSTRUCTED PER UCS DWG #100.
 2. CONSTRUCT CONTROL JOINTS WITHIN 24 HOURS OF POUR.

6 TOOLED CONTROL JOINT DETAIL
SCALE: NTS

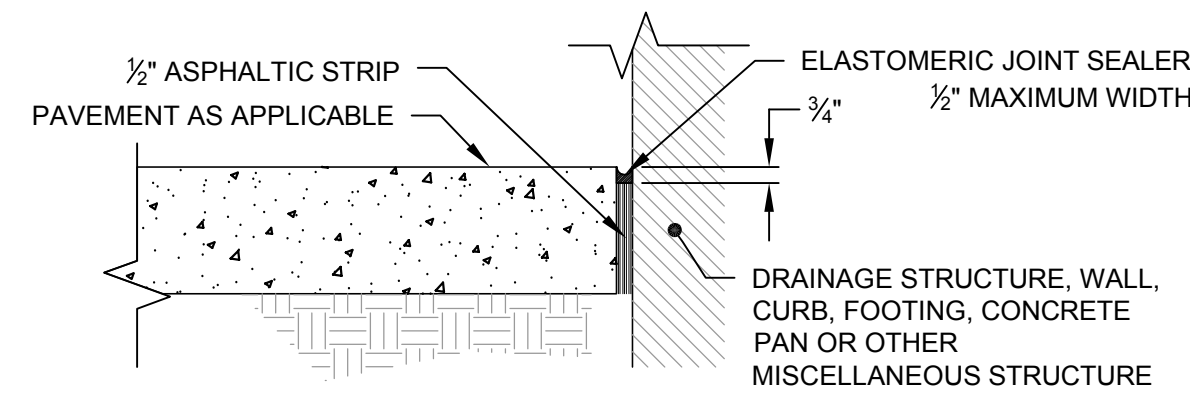

7 ISOLATION JOINT AT STRUCTURE
SCALE: NTS

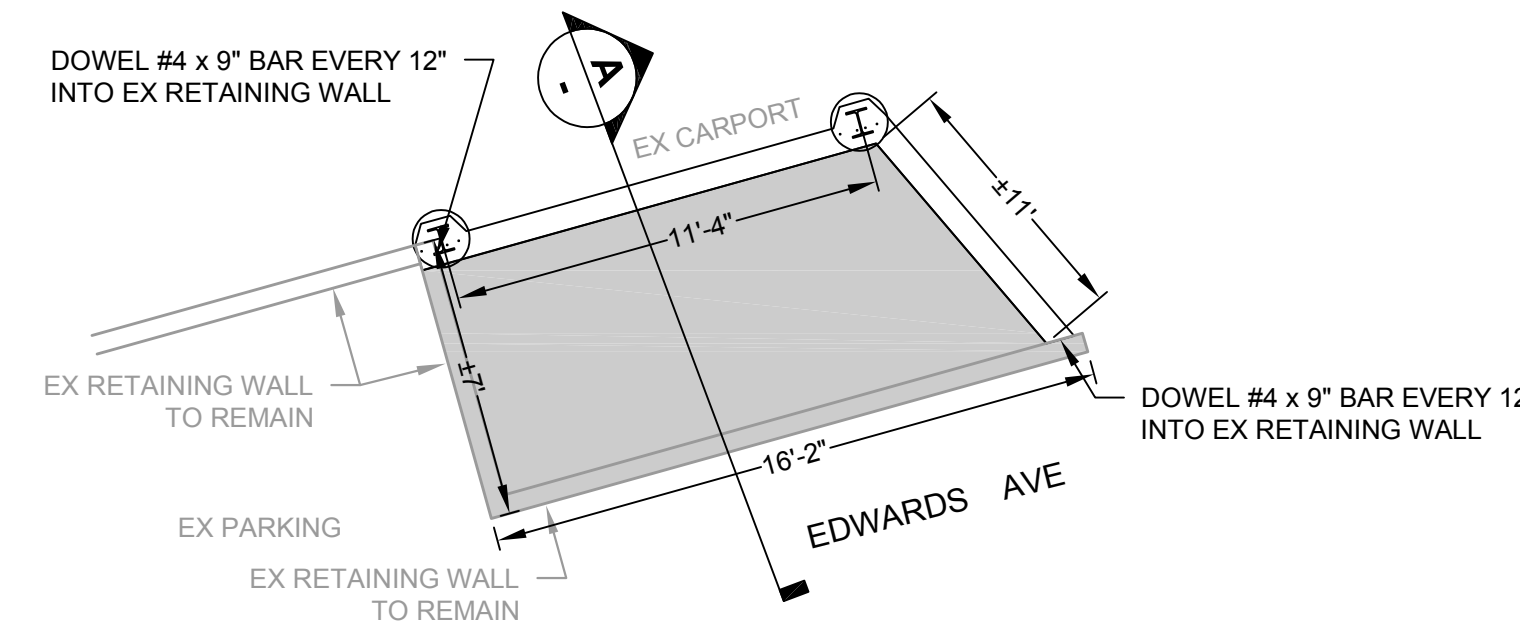

- NOTE:**
1. RELOCATE EX TELECOM AND ELECTRICAL CONDUIT AND CONDUCTORS AROUND NEW RETAINING WALL

PLAN VIEW

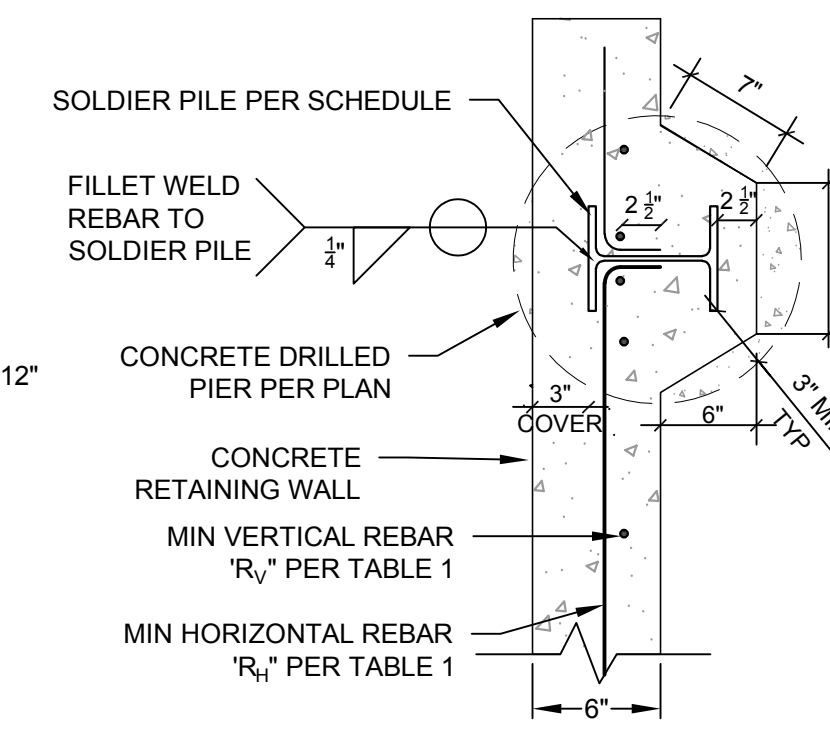

SOLDIER PILE DETAIL

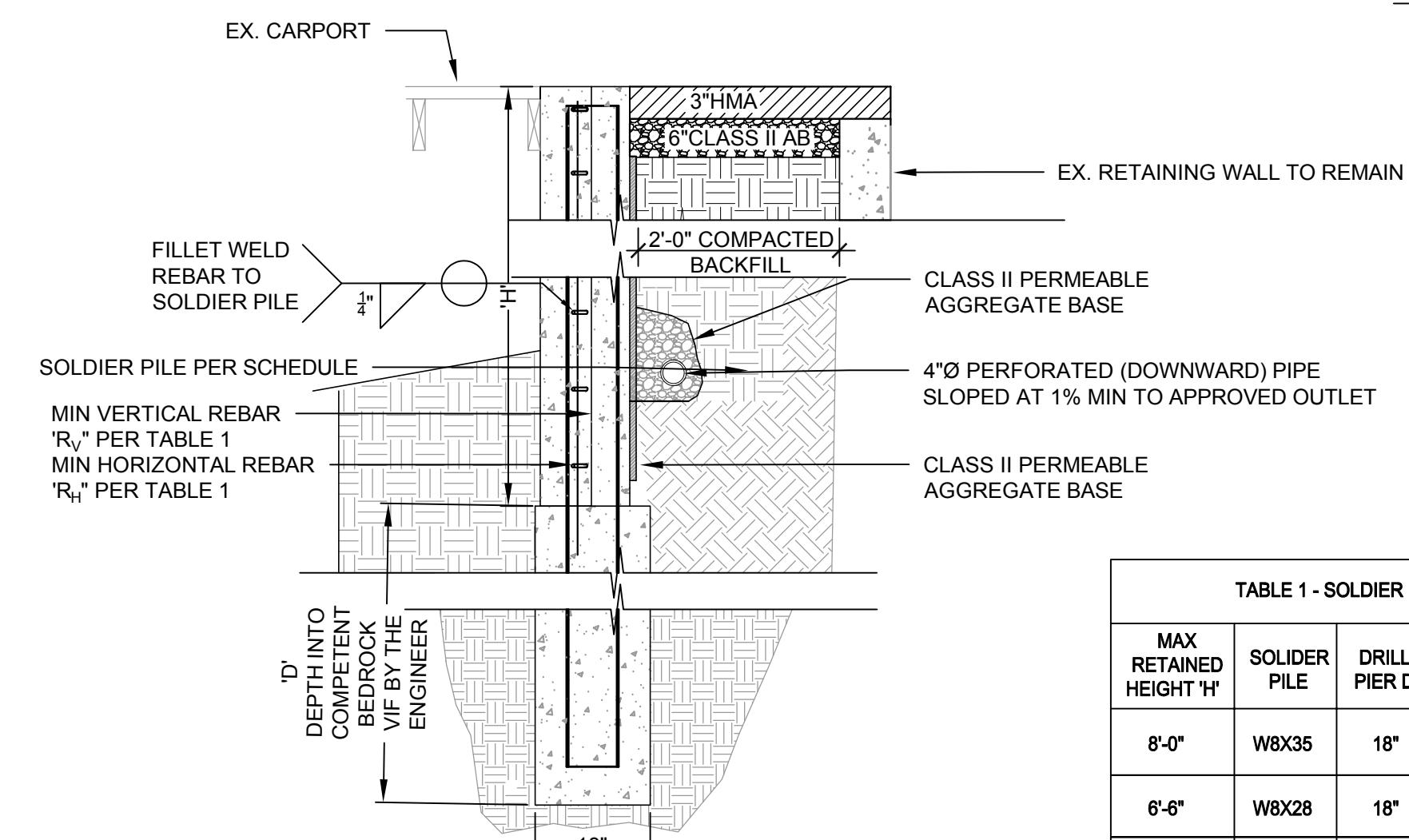

SECTION DETAIL "A"

| TABLE 1 - SOLDIER PILE RETAINING WALL SCHEDULE | | | | | |
|--|--------------|------------------|------------------------|--------------------|--------------------|
| MAX RETAINED HEIGHT 'H' | SOLDIER PILE | DRILLED PIER DIA | DEPTH INTO BEDROCK 'D' | MIN R _v | MIN R _h |
| 8'-0" | W8X35 | 18" | 14'-0" | #4 REBAR @12" O.C. | #6 REBAR @12" O.C. |
| 6'-6" | W8X28 | 18" | 12'-0" | #4 REBAR @12" O.C. | #6 REBAR @12" O.C. |
| 4'-0" | W8X10 | 18" | 8'-0" | #4 REBAR @12" O.C. | #5 REBAR @12" O.C. |

8 BID ALT #3 - 32 EDWARDS PARKING LOT DESIGN
SCALE: NTS



CSW | ST 2

CSW/Stuber-Stroeh Engineering Group, Inc.

504 Redwood Blvd
Novato, CA 94947
tel: 415.883.9850
fax: 415.883.9835

Civil Engineers
Surveying & Mapping
Land Planning
Construction Management

| Rev | Date | Description | Designed | Drawn | Checked |
|-----|----------|-------------|----------|-------|---------|
| A | 09/20/23 | BID SET | RJS | IP | RJS |

**STREET REHABILITATION
DETAIL SHEET
ROADWAY IMPROVEMENTS
SAUSALITO, CALIFORNIA**

City Of
Sausalito
County Of
Marin
State Of
California

Prepared Under the Direction of:

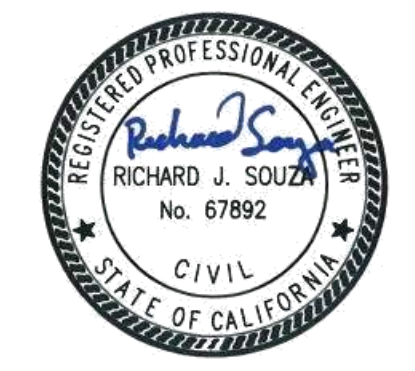

Sheet
C4.00
Scale: N.T.S.
Date: September 20, 2023
Sheet Number: 10 OF 11

| Rev | Date | Description | Designed | Drawn | Checked |
|-----|----------|-------------|----------|-------|---------|
| A | 09/20/23 | BID SET | RJS | IP | RJS |

STREET REHABILITATION
DETAIL SHEET
SANITARY SEWER
SAUSALITO, CALIFORNIA

City of
Sausalito
County of
Marin
State of
California

Prepared Under the Direction of:

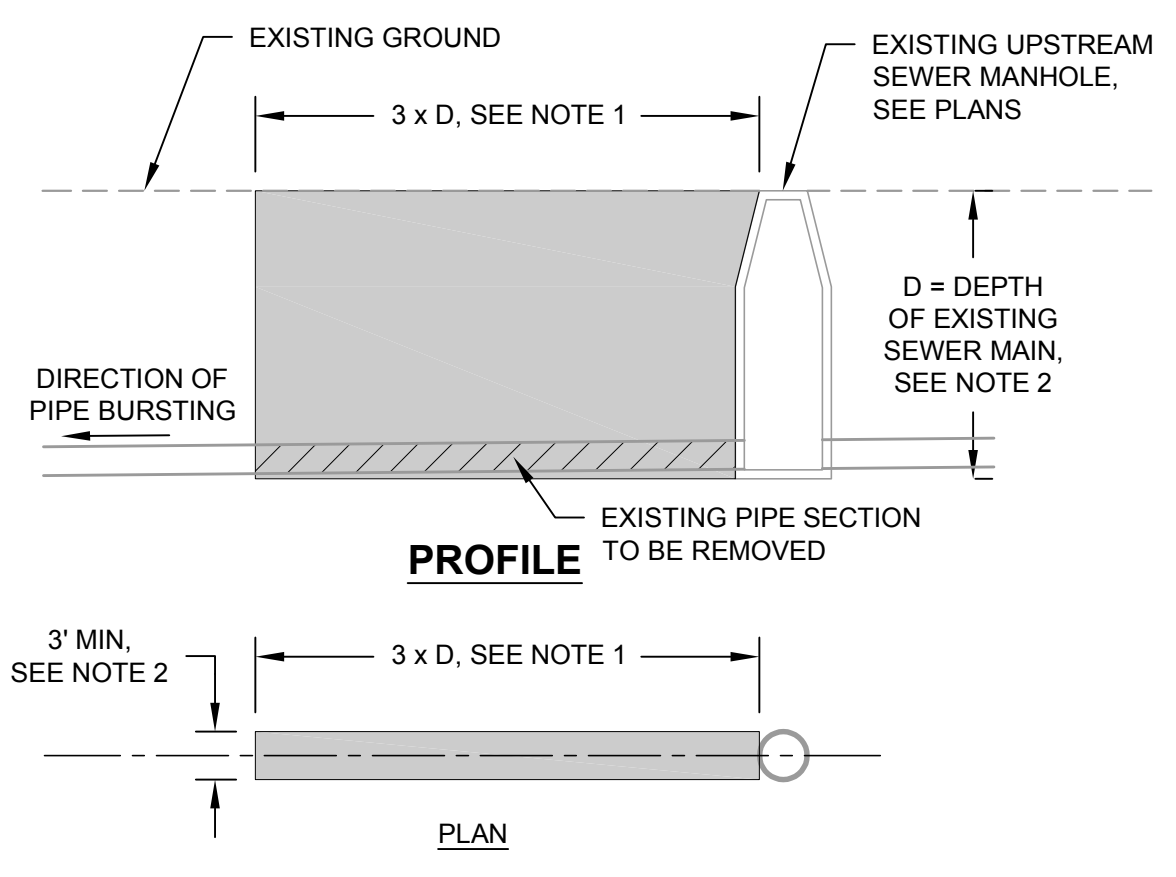
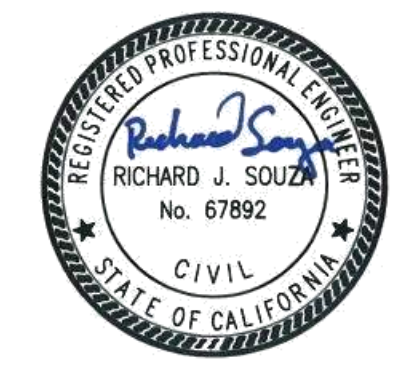

- NOTES:**
- TRENCH WALLS SHALL BE SHORED ON ALL EXCAVATED TRENCHES OVER 5 FEET IN DEPTH AS REQUIRED BY OSHA STANDARDS.
 - TRENCH WIDTH AND DEPTH SHALL BE DETERMINED BY CONTRACTORS MEANS AND METHODS.

1 EXCAVATION PIT DETAIL
SCALE: N.T.S.

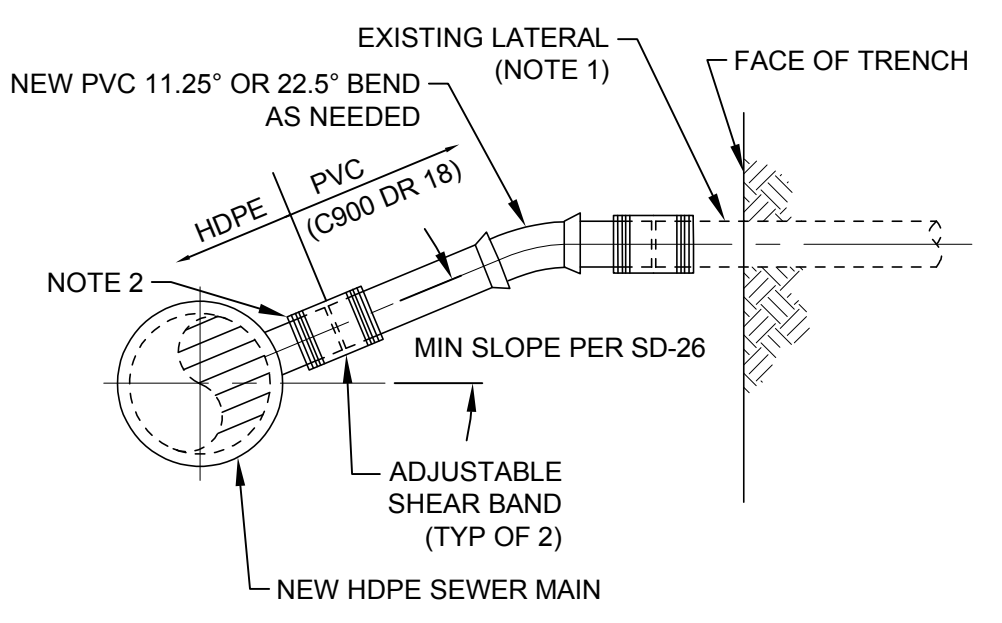

- NOTES:**
- EXTEND NEW LATERAL AS REQUIRED TO REMOVE DETERIORATED PIPE AND CONNECT TO PIPE IN GOOD CONDITION.
 - CONNECTION TO MAIN SEWER SHALL BE MADE WITH AN ELECTROFUSION SADDLE AS APPROVED BY THE ENGINEER. SADDLE CONNECTIONS TO MAIN EQUAL TO OR LESS THAN 12" DIAMETER (NOMINAL) SHALL BE "WYE" TYPE. SADDLE CONNECTIONS TO MAINS LARGER THAN 12" DIAMETER (NOMINAL) MAY BE "TEE" TYPE.

2 SIDE SEWER CONNECTION TO HDPE SEWER DETAIL
SCALE: N.T.S.

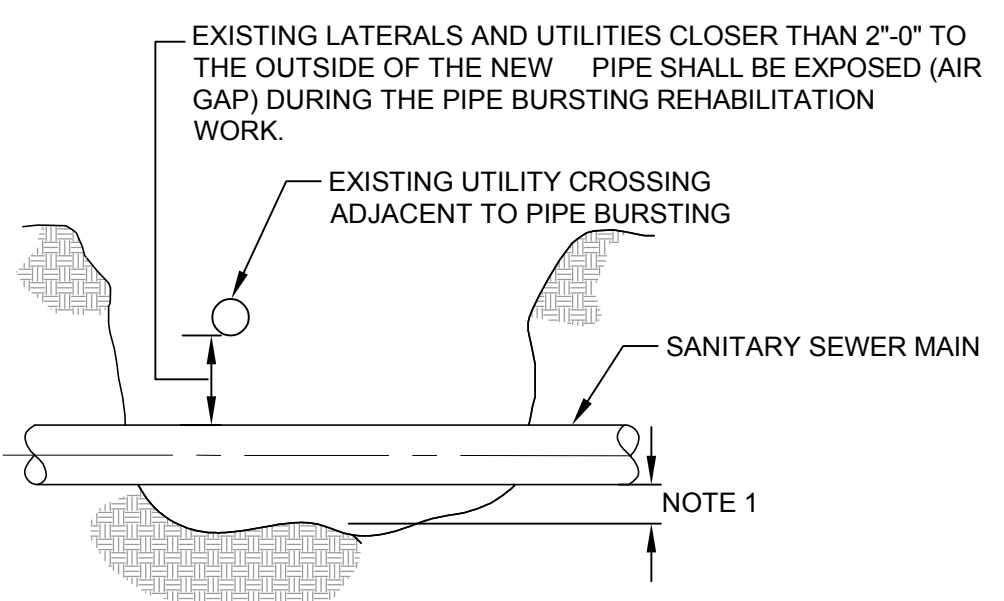

- NOTES:**
- EXCAVATE COMPLETELY AROUND THE SANITARY SEWER MAIN TO BE BURST. MAINTAIN 3" OF CLEARANCE FROM SOIL TO THE NEW PIPE OUTSIDE DIAMETER TO ENSURE THE BURSTING HEAD DOES NOT RAISE UP AT THESE LOCATIONS. REMOVE ANY LOOSE AND/OR NATIVE SOIL FROM THE EXCAVATION AFTER BURSTING/REAMING OPERATIONS AND PRIOR TO BACKFILLING.

3 AIR GAP FOR PIPE BURSTING DETAIL
SCALE: N.T.S.

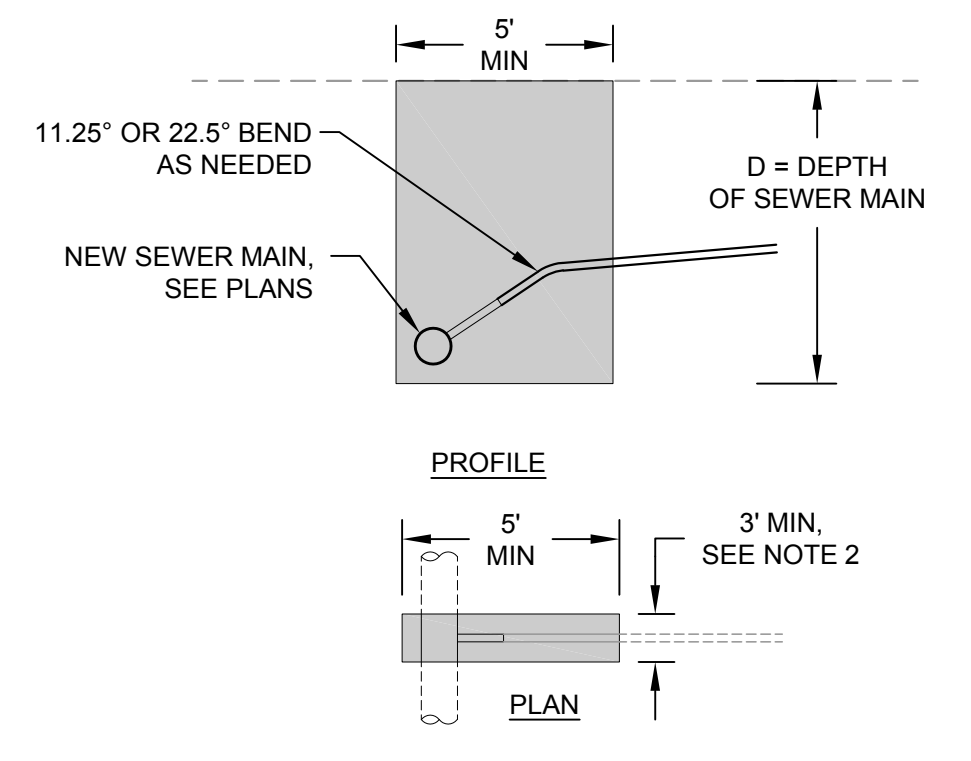

- NOTES:**
- EXCAVATE COMPLETELY AROUND THE SS MAIN TO BE BURST. MAINTAIN 3" OF CLEARANCE FROM SOIL TO THE NEW PIPE OUTSIDE DIAMETER TO ENSURE THE BURSTING HEAD DOES NOT RAISE UP AT THESE LOCATIONS.
 - REMOVE ANY LOOSE AND/OR NATIVE SOIL FROM THE EXCAVATION AFTER BURSTING/REAMING OPERATIONS AND PRIOR TO BACKFILL.

4 SIDE SEWER DISCONNECT FOR PIPE BURSTING DETAIL
SCALE: N.T.S.

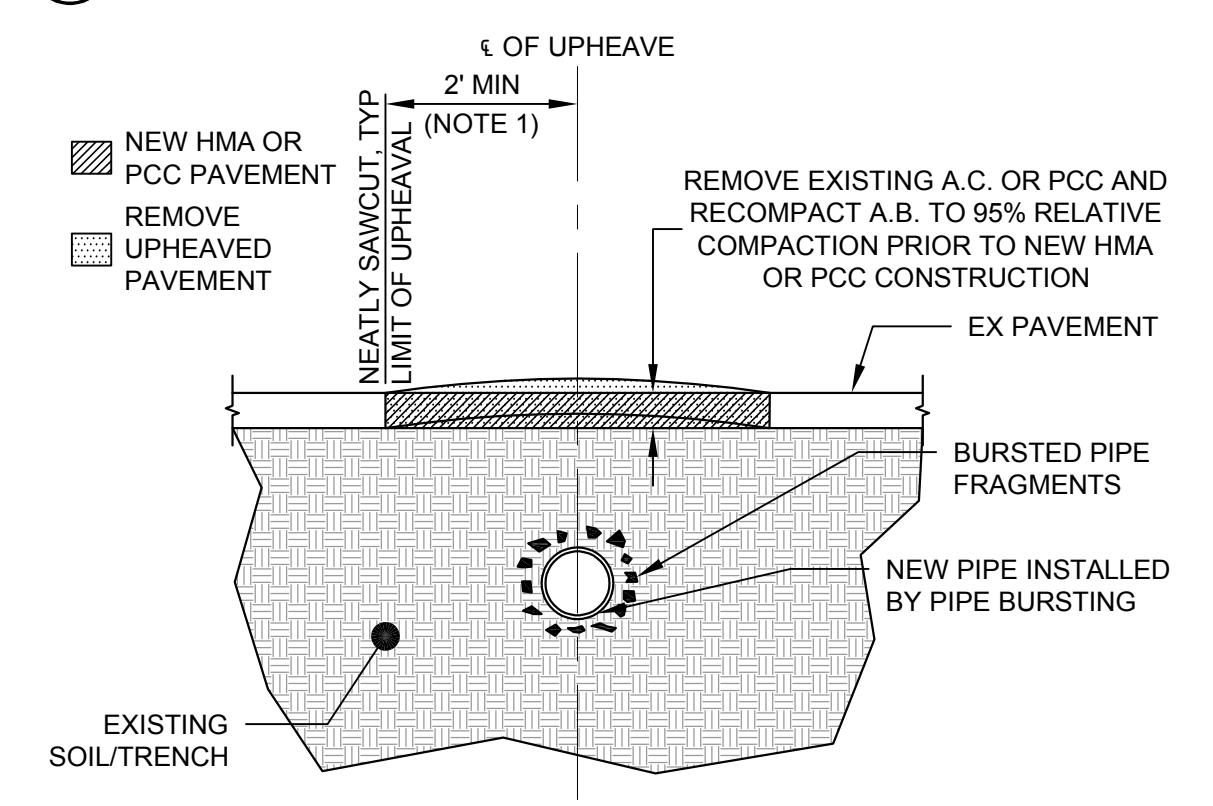

- NOTES:**
- LIMITS OF PAVEMENT REPAIR TO BE VERIFIED BY DISTRICT OR ITS APPOINTED REPRESENTATIVES AFTER PIPE BURSTING. WHERE LIMIT OF SURFACE UPHEAVAL REPAIR IS INDICATED IN THE DESIGN, SAWCUT FULL DEPTH OF PAVEMENT PRIOR TO BURSTING PIPE.

5 SURFACE UPHEAVAL REPAIR DETAIL
SCALE: N.T.S.

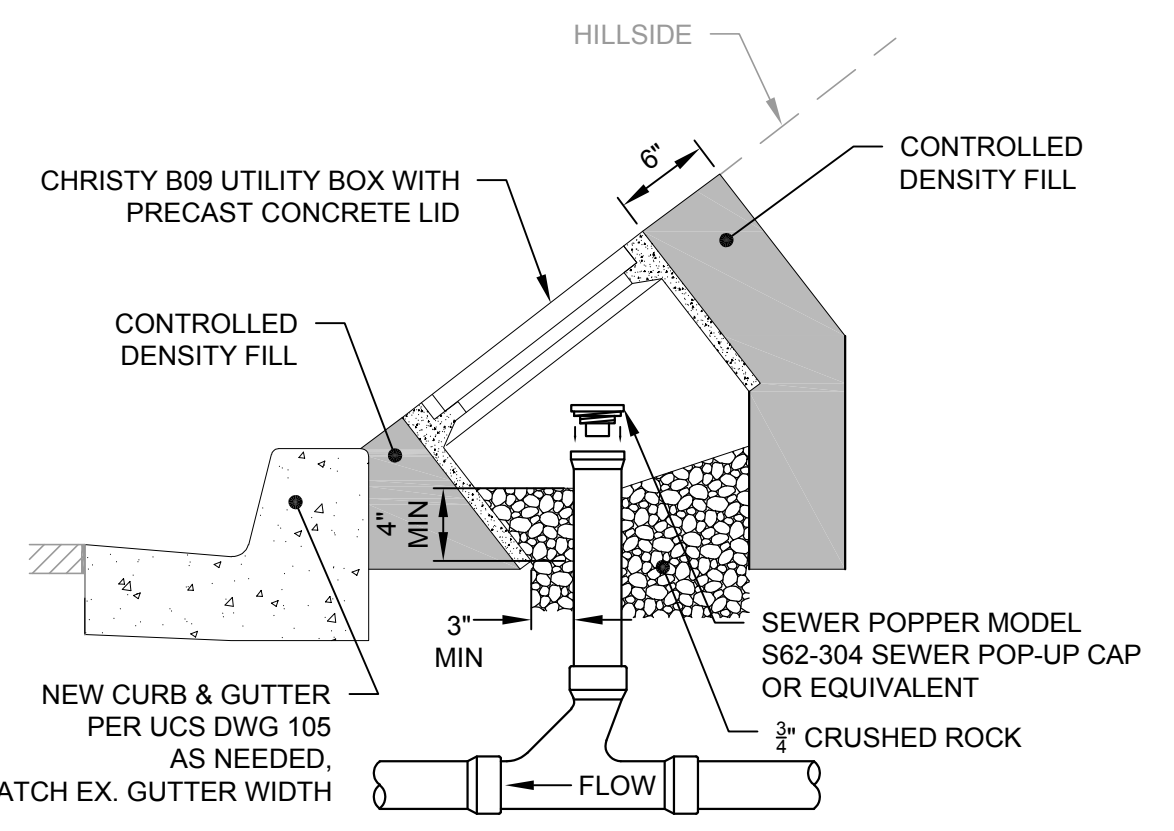

- NOTES:**
- SEWERPOPPER SHALL BE 3" BELOW THE BOTTOM OF THE LID GRATE.
 - SEWERPOPPER SHALL BE CENTERED EQUIDISTANTLY IN MIDDLE OF B09 BOX.

SANITARY SEWER CLEANOUT

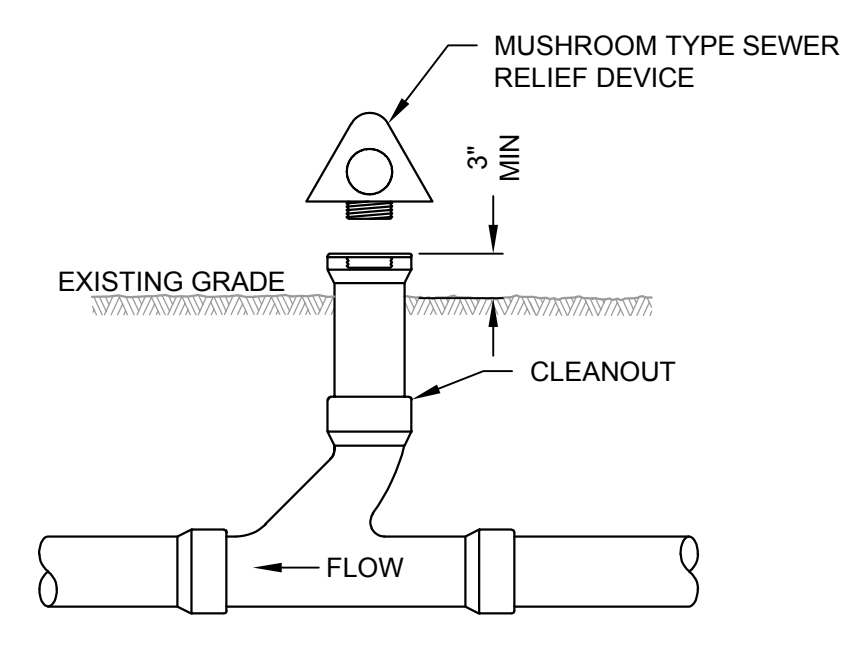

SANITARY SEWER CLEANOUT IN LANDSCAPE (WHERE APPROVED BY THE ENGINEER)

6 SANITARY SEWER CLEANOUT
SCALE: N.T.S.

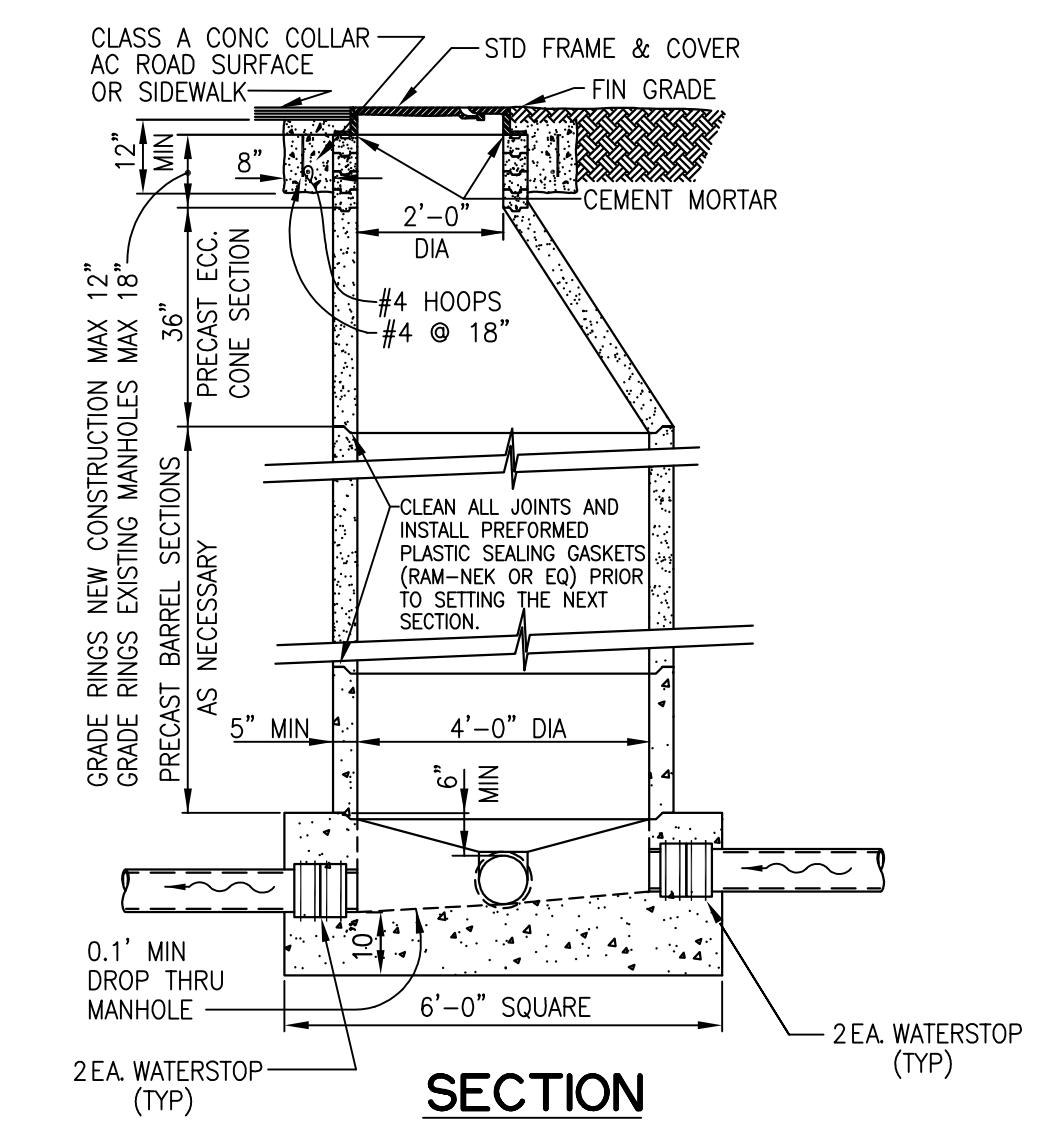

8 STANDARD SEWER MANHOLE
SCALE: N.T.S.

- NOTES:**
- MANHOLE BASE SHALL BE CLASS A (6-SACK) CONCRETE AND SHALL BE POURED AGAINST UNDISTURBED SOIL.
 - PRECAST CONCRETE CONE, BARREL AND GRADE RINGS SHALL CONFORM TO A.S.T.M. SPEC C-478, EXCEPT THAT TYPE II MODIFIED PORTLAND CEMENT SHALL BE USED.
 - ECCENTRIC CONE SECTION SHALL BE POSITIONED AS DIRECTED BY CITY.
 - RECESS IN MANHOLE BASE SHALL BE FORMED WITH AN APPROVED METAL FORMING RING TO RECEIVE PRECAST MANHOLE JOINT. PREFORMED PLASTIC SEAL BASKET SHALL BE INSTALLED BEFORE PLACING FIRST BARREL SECTION.
 - PRECAST MANHOLE BASES ARE NOT ALLOWED UNLESS SPECIFICALLY APPROVED BY THE CITY.

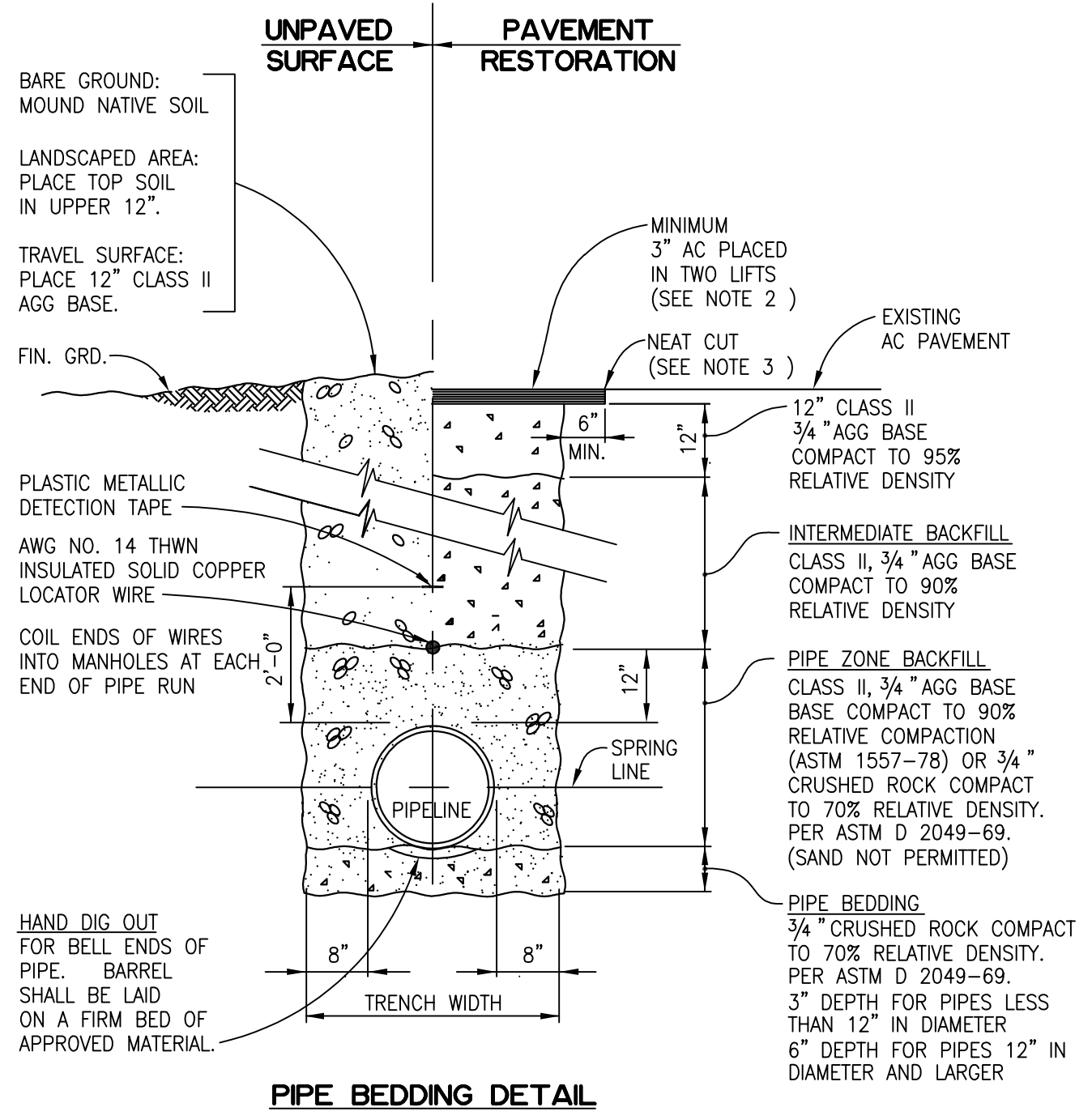
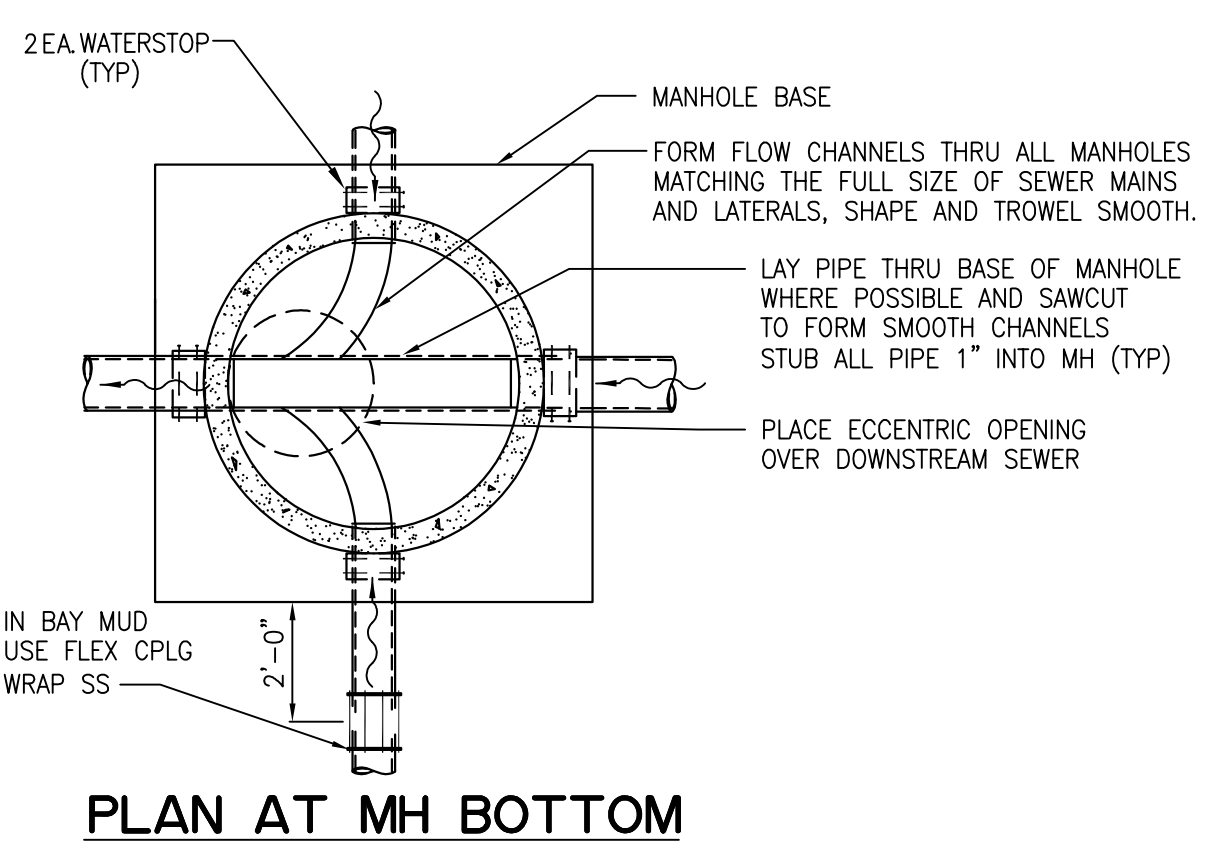

7 TYPICAL SANITARY SEWER TRENCH DETAIL
SCALE: N.T.S.

- NOTES:**
- INSTALL 4' LONG COMPACTED IMPERVIOUS CLAY OR SLURRY CEMENT PLUGS IN PIPE ZONE BACKFILL AND PIP BEDDING AT 400' INTERVALS.
 - ASPHALT THICKNESS SHALL CONFORM TO THE REQUIREMENTS OF THE AGENCY WITH JURISDICTION OVER STREET.
 - CONSULT LOCAL JURISDICTION FOR ASPHALT CUTTING REQUIREMENTS.
 - TRENCH SECTION DETAIL APPLIES TO BOTH SEWER MAINS AND SEWER LATERALS. TRACER WIRE IS NOT REQUIRED FOR SEWER LATERAL TRENCHES.
 - RECYCLED AGGREGATE BASE MAY CONTAIN ONLY RECYCLED CONCRETE. USE OF RECYCLED ASPHALT IS PROHIBITED.
 - DURING TRENCH OPERATIONS, FOR ALL TEMPORARY TRENCH RESTORATION, THE CONTRACTOR SHALL PLUG PAVE WITH HOT ASPHALT TO STREET GRADE AFTER REMOVAL OF STEEL PLATES.
 - CONTRACTOR IS RESPONSIBLE TO PROVIDE ADEQUATE SHORING TO PREVENT MOVEMENT OF ADJACENT GROUND INCLUDING CAVE-INS WHERE NEW SEWER TRENCH IS INSTALLED ADJACENT TO EXISTING UTILITIES. THE CONTRACTOR SHOULD EXPECT UTILITIES ARE BACKFILLED WITH SAND, PEA GRAVEL, OR OTHER UNSTABLE MATERIALS. THE CONTRACTOR SHALL BE RESPONSIBLE TO REPAIR ANY CAVE-INS THAT OCCUR BEYOND THE NEW SEWER TRENCH MARGINS AT NO COST TO THE DISTRICT.
 - CONTRACTOR MAY ENCOUNTER SOFT, WET SOILS DURING EXCAVATION.
 - IF CONTRACTOR CANNOT ADEQUATELY COMPACT TRENCH DUE TO OTHER UTILITIES, THE DISTRICT REPRESENTATIVE SHALL BE NOTIFIED AND A CDF BACKFILL SHALL BE USED AT NO ADDITIONAL COST TO THE DISTRICT.